

VALVES, PIPE FITTINGS, GAS EQUIPMENT, HOSE & CLIPS



Aquafax Limited
14 Dencora Way
Sundon Business Park
Luton
Beds LU3 3HP
Tel: (01582) 568700
Fax: (01582) 568720

e-mail: sales@aquafax.co.uk
website: www.aquafax.co.uk

Aquafax Limited (Hamble)
12-13 Mitchell Point
Ensign Business Park
Hamble
Southampton SO31 4RF
Tel: (023) 8045 7206
Fax: (023) 8045 7208

Aquafax Limited (Nantwich)
Venetian Marina Village
Cholmondeston
Nantwich
Cheshire CW5 6DD
Tel: (01270) 528822
Fax: (01270) 528833

Aquafax Limited (Wroxham)
Unit 31 Littlewood Lane
Stalham Road Ind. Estate
Hoveton
Norfolk NR12 8DZ
Tel: (01603) 781881
Fax: (01603) 781981

2-6	<i>Ball Valves</i>
7-9	<i>Filters/Valves</i>
10&12	<i>Hose Connectors</i>
11,13-15	<i>Pipe Fittings</i>
16	<i>Kwick-Kam Couplings</i>
16-17	<i>Hoses</i>
18	<i>Fuel Hoses/Tubing</i>
19-21	<i>Hose Clamps/Glips</i>
22-27	<i>Compression Fittings</i>
28-33	<i>Gas Fittings & Equipment</i>
34	<i>Miscellaneous</i>
35-36	<i>Carded Information</i>

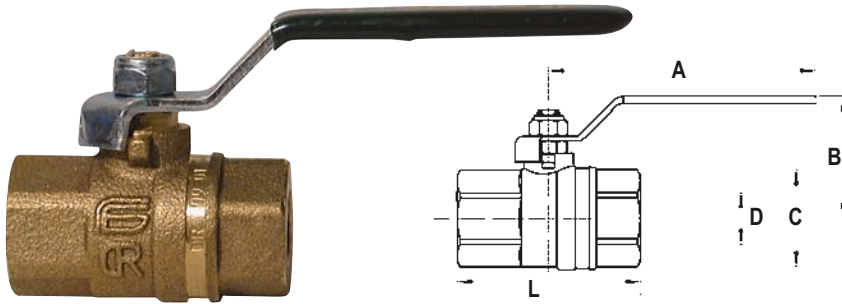

ISIS DZR BALL VALVE

The ISIS is a robust, dezincification resistant ball valve that is particularly suitable for those installations where high aggressive water causes zinc leaching in the standard brass alloys and weakens the material molecular structure.

Features:

- Dezincification resistant materials
- Blow-out proof stem
- Full bore
- Very fast opening/closing in case of emergency
- No maintenance - equipped with wrapping seats ensuring long life cycles
- Antifriction ring forms the first automatic sealing at high pressure
- Two self adjusting cone shaped seals, with Teflon sliding for second sealing at low pressure
- 1 'O' ring in EPDM for sealing at low pressure and vacuum
- All valves are tested according to a strict procedure covering severe inspections on the entire production
- Certified by *British Gas* and the *Water Research Centre* in Thread ISO7/1 Rp

Suitable for:

- Inlet for cooling engines
- Generators
- Air conditioning
- Refrigeration units
- Deck drain outlets
- Exhaust outlets
- Seawater inlets for toilets
- Seawater outlets for toilets

Temperature Limits:

Fluids: -15°C to +120°C

Gas: -20°C to +60°C

Pressure Limits:

Fluids: 25 Bar

Gas: PN4

Thread: Female Parallel Thread ISO 228/1 (BS 2779)

BSP	A	B	C	L	D Bore	Part No.
1/4"	85	37	27	49	10	1-70899
3/8"	85	37	27	50	10	1-70900
1/2"	85	44	32	61	15	1-70901
3/4"	105	52	40	70	20	1-70902
1"	105	56	48	84	25	1-70903
1 1/4"	130	63	60	98	32	1-70904
1 1/2"	130	69	72	108	40	1-70905
2"	165	83	88	130	50	1-70906
2 1/2"	250	95	85	160	65	1-70907
3"	250	100	99	180	80	1-70908

Materials:

Body & Threaded End:	DZR Copper alloy CW602N (UNI EN 12165)
Gland:	DZR Copper alloy CW614N (UNI EN 12164)
Stem:	DZR Copper alloy CW602N (UNI EN 12164)
Ball:	Chrome Plated DZR Copper alloy CW602N (UNI EN 12164)
Seals:	Pure PTFE (Teflon)
O-ring:	EPDM
Lever:	Zinc plated steel, PVC coated Grip
Fixing Nut:	Zinc plated steel

DEZINCIFICATION RESISTANCE



Why specify DZR Copper Alloy?

In certain aggressive water supplies, the dezincification of brass valves used to be a problem. However, with the introduction of the ISIS Ball Valve range in dezincification resistant copper alloy (CZ132) the use of more expensive alternatives can be avoided.

ISIS protects against the leaching of zinc that can result in the failure of brass components. Also avoided is the risk of blockage due to the formation of a soft, white 'meringue' corrosion product containing basic-zinc carbonate.

Dezincification resistant copper, alloy is now specified in BS EN 12165, the alloy being designated CW602N (CZ132).

The symbol above indicates that ISIS valves have been manufactured to be dezincification resistant and will satisfy the requirements of the British Standard dezincification test.

Dezincification resistance of CW602N (CZ132) alloy is maintained in seawater high in chlorides and other aggressive agents.

Lloyds Register of Shipping Yacht and Small Craft Department accept the use of DZR copper alloy in through-hull fittings.

BRONZE BODIED BALL VALVES

- FF PN32 full flow lever ball valve
- Female Parallel Thread: BSP = ISO7/1(BS21)
- Lever handle zinc plated steel, PVC coated grip
- Smaller sizes available but we recommend the DZR ball valve above

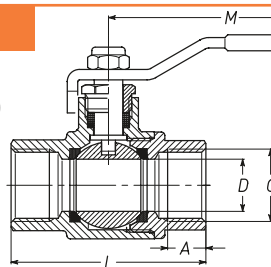

Materials:

Body:	Bronze
Gland:	Brass CW 614N
Stem:	Brass CW 614N
Ball:	Chrome Plated Brass

BSP	A	D	L	H	M	Part No.
2 1/2"	28	60	142	120	200	1-71747
3"	31	76	178	144	280	1-71748
4"	33	95	210	165	280	1-71749

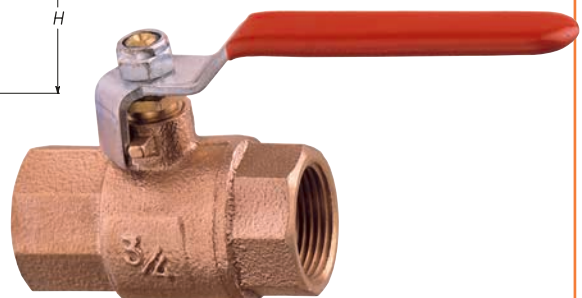

BALL VALVES FOR GAS

A high specification ball valve. Ideal for gas. Also suitable for hot & cold water, compressed air, pneumatic, hydraulic, and most industrial fluids.

Features:

- Quarter turn operation
- 100% full bore
- Individually tested
- **BG plc approved**

Materials:

Body:	Nickel plated brass CW 617N
Ball:	Hard chrome-plated brass CW 617N
Stem:	Brass CW 614N
Seal:	Pure teflon (P.T.F.E)
O Rings:	Viton / NBR
Lever handle:	Yellow coated zinc-plated steel Fe.P04
 Tee handle:	Yellow coated aluminium UNI 5076

Working Temperatures:

Gas:	-15°C to 60°C
Air:	-15°C to 150°C
Water (no steam):	0°C to 150°C*

* Warning: the formation of ice can severely damage valves & piping

Technical Specifications:

Male: BSP Taper Thread - ISO 7/1R BS21 DIN 2999
 Female: BSP Parallel Thread ISO 7/1Rp BS21 DIN 2999
 Bar* - Pressure Atmosphere kg/cm³
 PSI* - LBS working pressure
 Box* - All valves are sold & priced as each. Box quantities shown are for information purposes.

FEMALE/FEMALE LEVER

BSP	A	B	C	D	E	CH	Bar*	PSI*	Box*	Part No.
¼"	51	25	40	80	10	18	5	72.5	12	1-70909
⅜"	60	25	40	80	10	21	5	72.5	12	1-70910
½"	75	32	50	89	15	25	5	72.5	12	1-70911
¾"	80	42	59	113	20	31	5	72.5	8	1-70912
1"	90	49	63	113	25	40	5	72.5	6	1-70913
1¼"	110	59	77	138	32	49	5	72.5	4	1-70914
1½"	120	72	91	158	40	54	5	72.5	2	1-70915
2"	140	86	97	158	50	68	5	72.5	2	1-70916

MALE/FEMALE LEVER

BSP	A	B	C	D	E	CH	Bar*	PSI*	Box*	Part No.
¼"	58	25	40	80	10	18	5	72.5	12	1-70929
⅜"	63	25	40	80	10	21	5	72.5	12	1-70930
½"	77	32	50	89	15	25	5	72.5	12	1-70931

FEMALE/FEMALE TEE

BSP	A	B	C	D	E	CH	Bar*	PSI*	Box*	Part No.
¼"	51	25	37	47	10	18	5	72.5	15	1-70919
⅜"	60	25	37	47	10	21	5	72.5	15	1-70920
½"	75	32	47	54	15	25	5	72.5	12	1-70921
¾"	80	42	49	62	20	31	5	72.5	8	1-70922
1"	90	49	52	62	25	40	5	72.5	8	1-70923

MALE/FEMALE TEE

BSP	A	B	C	D	E	CH	Bar*	PSI*	Box*	Part No.
¼"	58	25	37	47	10	18	5	72.5	12	1-70939
⅜"	63	25	37	47	10	21	5	72.5	12	1-70940
½"	77	32	47	54	15	25	5	72.5	12	1-70941

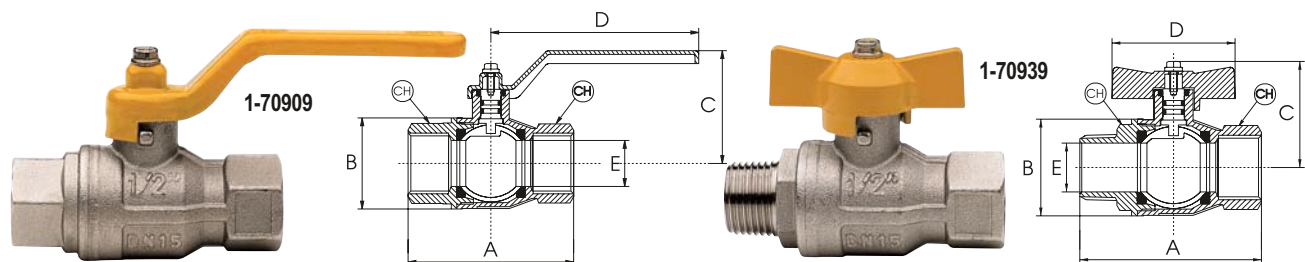

Technical Specifications

- Body material: forged brass nickel plated
- Ball material: brass nickel/chrome plated
- Body seal: Teflon PTFE
- Shaft seal: nitrile 2 x NBR (max. temp + 90°C)
- Handle: nylon 6:6 - glass fibre reinforced (max. temp+ 210°C)
- Max. operating pressure: 20 bar
- Anti-blow out stem with 1/4 turn positive shut-off
- Full bore operation - minimum pressure drop
- 100% factory tested
- Conforms to European Standard for Gas Valves - EN 331:1995
- Also suitable for diesel

Note: if installing in a gas system using copper pipe the brass olives must be exchanged for copper olives to comply with EN ISO 10239:2000 (6.2.4)

- 1-19024 ¼" pack of 10 Copper compression olives
- 1-19025 ⅜" pack of 10 Copper compression olives
- 1-19026 ½" pack of 10 Copper compression olives

MINI GAS/DIESEL BALL VALVES

A range of mini gas ball valves with integral foot mount

COMPRESSION x COMPRESSION OR 8MM NOZZLE

These valves are designed for pipe to pipe applications or hose to copper pipe with an integral foot mount for a secure hold without additional pipe supports. All come complete with nuts and brass olives.

Compression	x Compression	Part No.	x Hose ID	Part No.
¼"	¼"	1-59100	8mm	1-59120
⅜"	⅜"	1-59101	8mm	1-59121
½"	½"	1-59102	8mm	1-59122

BSP FEMALE x FEMALE WALL MOUNTED VALVES

These valves are designed for wall or panel mounting and are fitted with adjustable steel wall brackets.

Part No.	Description
1-59115	¼" BSP Female / Female and wall bracket
1-59117	½" BSP Female / Female and wall bracket

15mm x15mm VALVE WITH COMPRESSION FITTINGS

This valve is designed for wall or panel mounting & is complete with steel wall bracket. It has a 13mm ball aperture for minimum pressure drop. Comes complete with nuts & brass olives. **Part No. 1-59109**

NOTE: All valves are sold and priced as each.
 Box quantities shown are just for information purposes.

ITAP BALL VALVES

Good quality full flow ball valves at competitive prices. Suitable for industrial, pneumatic & hydraulic installations, including gasoline, fuel oils, kerosene, petrol & diesel. Ideal for hot & cold water, different oils & compressed air.

- Minimum 100,000 operation design
- 90 degree movement by either lever or tee handle

Materials:	
Body:	Nickel plated brass CW 617N
Ball:	Hard chrome-plated brass CW 617N
Stem:	Brass CW 614N
Seal:	Pure teflon (P.T.F.E)
O Rings:	Viton / NBR
Lever handle:	Red coated zinc-plated steel Fe.P04
Tee handle:	Red coated aluminium UNI 5076

Working Temperatures:

Air: -15°C to 220°C

Water (no steam): 0°C to 150°C*

* Warning: the formation of ice can severely damage valves & piping

Technical Specifications:

BSP Parallel Thread - ISO228 BS2779 DIN259

Bar* - Pressure Atmosphere kg/cm³

PSI* - LBS working pressure

Box* - All valves are sold & priced as each. Box quantities shown are for information purposes.

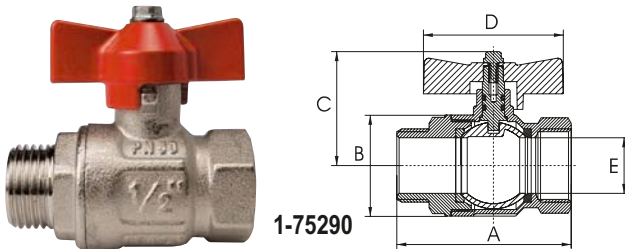
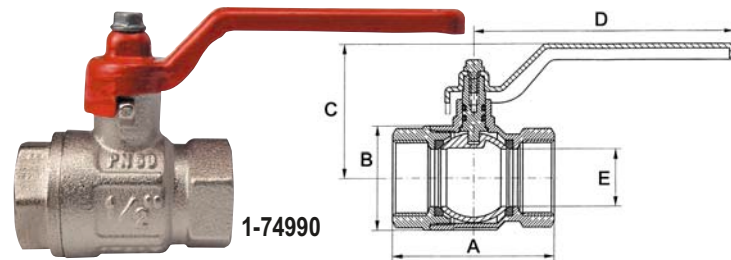

FEMALE/FEMALE LEVER

BSP	A	B	C	D	E	Bar*	PSI*	Box*	Part No.
1/4"	44	23	37	80	10	50	710	12	1-74990
3/8"	44	24	37	80	10	50	710	12	1-75000
1/2"	50	30	41	80	15	50	710	12	1-75010
3/4"	57	37	55	113	20	40	570	8	1-75020
1"	70	45	59	113	25	40	570	8	1-75030
1 1/4"	80	57	74	137	32	30	430	4	1-75040
1 1/2"	94	70	80	137	40	30	430	2	1-75050
2"	112	84	96	157	50	25	360	2	1-75060
2 1/2"	134	110	117	197	65	18	260	1	1-75070
3"	156	131	129	250	80	16	230	1	1-75080
4"	190	164	143	250	100	14	200	1	1-75084

MALE/FEMALE LEVER

BSP	A	B	C	D	E	Bar*	PSI*	Box*	Part No.
1/4"	54	23	37	80	10	50	710	12	1-75090
3/8"	54	24	37	80	10	50	710	12	1-75100
1/2"	59	30	41	80	15	50	710	12	1-75110
3/4"	65	37	55	113	20	40	570	8	1-75120
1"	77	45	59	113	25	40	570	8	1-75130
1 1/4"	90	57	74	137	32	30	430	4	1-75140
1 1/2"	105	70	80	137	40	30	430	2	1-75150
2"	122	84	96	157	50	25	360	2	1-75160

FEMALE/FEMALE TEE

BSP	A	B	C	D	E	Bar*	PSI*	Box*	Part No.
1/4"	44	23	36	47	10	50	710	12	1-75190
3/8"	44	24	36	47	10	50	710	12	1-75200
1/2"	50	30	40	47	15	50	710	12	1-75210
3/4"	57	37	48	62	20	40	570	8	1-75220
1"	70	45	52	62	25	40	570	8	1-75230

MALE/FEMALE TEE

BSP	A	B	C	D	E	Bar*	PSI*	Box*	Part No.
1/4"	54	23	36	47	10	50	710	15	1-75290
3/8"	54	24	36	47	10	50	710	15	1-75300
1/2"	59	30	40	47	15	50	710	12	1-75310
3/4"	65	37	48	62	20	40	570	8	1-75320
1"	77	45	52	62	25	40	570	8	1-75330

PEGLER BALL VALVES

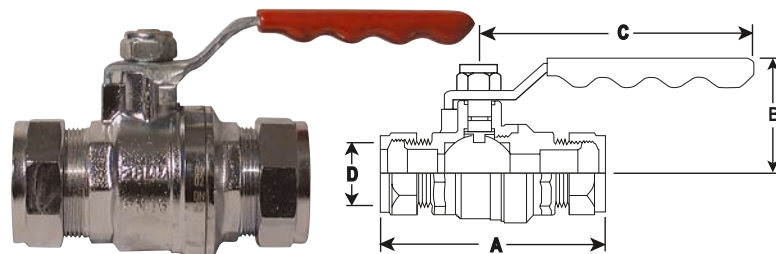

PEGLER BALL VALVES WITH BS864 COMPRESSION ENDS

Suitable for: steam, water, oil and air.

- Also suitable for inert, combustible[†] & corrosive^{††} gases
- All sizes rated PN16
- Full bore with quarter turn operation
- Blow-out and vandal-proof assembly
- Prestex compression ends to EN 1254/2 (BS864/2)

Size	A	B	C	D	Part No.
15mm	77	39	91	15	1-70880
22mm	88	50	105	20	1-70881
28mm	96	55	105	25	1-70882

† The valves are suitable for British Gas Applications Family Gases 1, 2 & 3

†† Suitable in applications where moisture is completely absent

Materials:

Ball, Body & End Piece:	Chrome Plated Brass
Stem:	Brass Bar
Seats & Thrust Washer:	P.T.F.E. (Teflon)
Stem O-Ring:	Viton
Red Lever:	PVC insulated Zinc Plated Steel
Nut (Self locking):	Zinc Plated Steel
Compression Nut:	Chrome Plated Brass
Compression Cone:	Brass

Pressure - Bar

Max Pressure up to 30°C	Max Pressure up to 120°C	Test Pressure Shell	Test Pressure Seat
16	5	24	17.6

Pressure - PSI

Max Pressure up to 86°F	Max Pressure up to 248°F	Test Pressure Shell	Test Pressure Seat
232.1	72.5	348.1	253.8

'L' PORT & 'T' PORT BALL VALVES

The higher rated model, PN32 has restricted flow and individual port sealing. The cheaper full flow type has a lower pressure rating of PN16. Both are made in nickel plated brass, with chromed ball, P.T.F.E. sealing and painted pressed steel levers.

- 'L' port allows two of three ports open only. i.e. for diverting.
- 'T' port allows as 'L' port or allows all ports open.

L-PORT



T-PORT

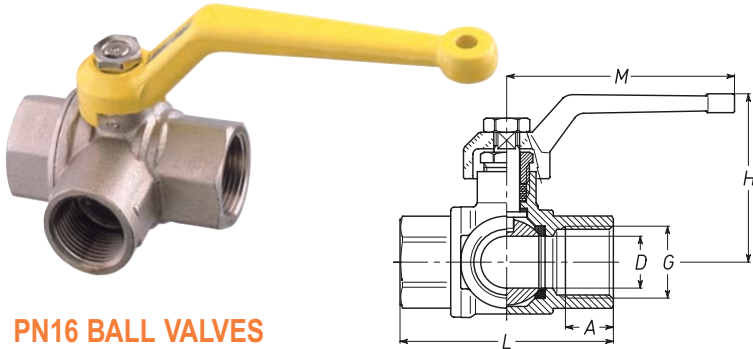
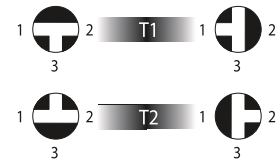

PN16 BALL VALVES

- G/BSP = Female Taper Thread ISO 7/1 (BS21)

G/BSP	A	D	L	H	M	L Port	T Port
1/4"	10	10	46	48	110	1-71809	1-71909
3/8"	11	10	52	48	110	1-71810	1-71910
1/2"	15	15	66	50	110	1-71811	1-71911
3/4"	16	20	76	62	130	1-71812	1-71912
1"	19	25	90	67	130	1-71813	1-71913
1 1/4"	21	32	110	82	159	1-71814	1-71914
1 1/2"	21	40	120	88	159	1-71815	1-71915
2"	26	50	140	109	188	1-71816	1-71916

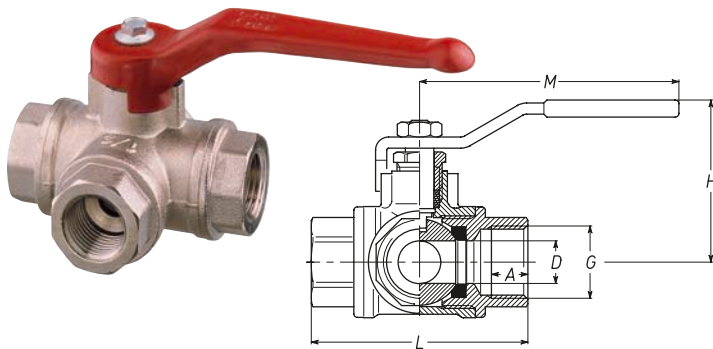

PN32 BALL VALVES

- G/BSP = Female Parallel Thread ISO 228/1 (BS 2779)
- Suitable for hydraulic, hot & cold water, compressed air, and non-corrosive fluids

Working Temperature: -20°C to 150°C

G/BSP	A	D	L	H	M	L Port	T Port
1/4"	12	10	74	56	90	1-71799	1-71899
3/8"	12	10	74	56	90	1-71800	1-71900
1/2"	14	12	80	62	125	1-71801	1-71901
3/4"	16	15	90	66	125	1-71802	1-71902
1"	19	20	105	73	140	1-71803	1-71903
1 1/4"	21	25	115	76	140	1-71804	1-71904
1 1/2"	23	32	138	97	220	1-71805	1-71905
2"	26	40	161	104	220	1-71806	1-71906

Materials:

Body:	Nickel plated brass CW617N
Ball:	Chrome plated brass CW617N
Stem:	Brass CW617N
Seat:	PTFE

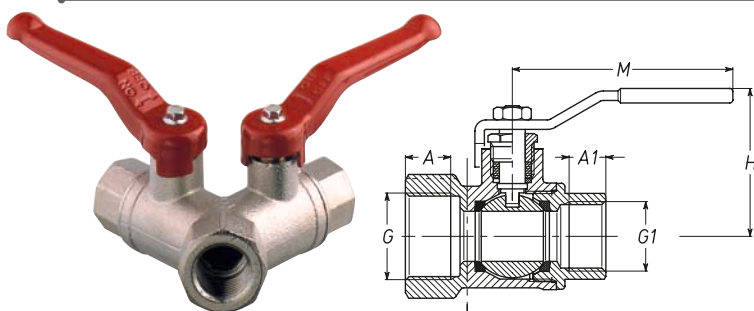

'Y' BALL VALVE DOUBLE OUTLET

- Nickel plated brass body and polished Chrome ball in Brass
- Teflon sealing
- Plasticized steel lever
- G/BSP = Female Parallel Thread ISO 228/1 (BS 2779)

G*/BSP	G1	A/A1	H	M	Part No.
1/2"	3/8" x 3/8"	15	54	90	1-75941
3/4"	1/2" x 1/2"	15	54	90	1-75942
1"	3/4" x 3/4"	16	58	125	1-75943
1 1/4"	1" x 1"	16	58	125	1-75944

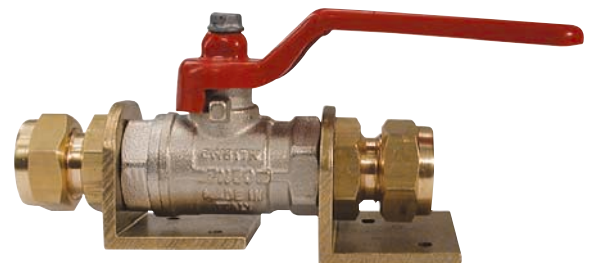

BALL VALVE BRACKET

Brass R/Angle bracket drilled for compression fitting, securing when threaded into valve, at each end. Two hole base fixing.

Description	Part No.
For 1/4" BSP Valves	1-74985
For 3/8" BSP Valves	1-74986
For 1/2" BSP Valves	1-74987



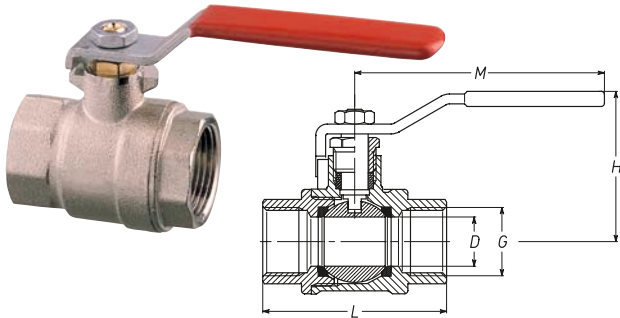

BALL VALVES

- High Specification PN30 Rated
- Forged Brass Body, Nickel plated
- Nickel Chrome plated mirror finish solid ball
- Plated Steel lever handle with plastic grip
- Full Flow
- G/BSP Parallel Female Thread ISO 228/1 (BS 2779)

G/BSP	D	L	H	M	Part No.
1/4"	10	44	41	77	1-71699
3/8"	10	44	41	77	1-71700
1/2"	15	50	46	100	1-71701
3/4"	20	58	49	100	1-71702
1"	25	68	62	120	1-71703
1 1/4"	32	80	67	120	1-71704
1 1/2"	40	93	85	157	1-71705
2"	50	110	92	157	1-71706



BULKHEAD FITTING BALL VALVE

Suitable for: industrial pneumatic & hydraulic installations. Ideal for hot/cold water, different oils & compressed air.

- Useful for shower, or fuel taps, particularly cockpit fitting
- Max. bulkhead thickness 25mm
- Exterior chromed brass lever and s/s back plate
- F/F BSP Parallel Thread ISO 228 - DIN 259 - BS2779

Working Temperatures: -20°C to 110°C*

* Warning: The formation of ice can severely damage this valve

BSP	A	B	C	D	E	F	G	H	Bar	PSI	Part No.
1/2"	56	34	100	76	15	27	29	70	30	430	1-75342
3/4"	66	43	111	76	20	34	32	70	25	360	1-75343

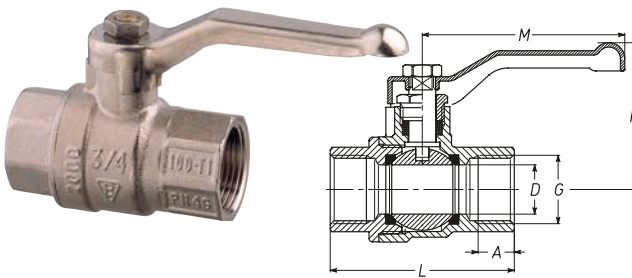

BRASS HANDLED BALL VALVES

A good quality valve with nickel plated brass lever handle which won't rust or corrode like normal commercial models.

- Full flow, PN 40 rated
- Made in brass with nickel plated body
- PTFE Seat
- G/BSP Parallel Female Thread ISO 228/1 (BS 2779)

G/BSP	A	D	L	H	M	Part No.
1/4"	10	10	45	32	80	1-71719
3/8"	10	10	45	32	80	1-71720
1/2"	15	15	63	50	92	1-71721
3/4"	16	20	71	53	92	1-71722
1"	19	25	83	63	115	1-71723
1 1/4"	21	32	92	67	115	1-71724
1 1/2"	21	40	104	82	150	1-71725
2"	26	50	124	90	150	1-71726
2 1/2"	27	61	140	110	260	1-71727

Working Temperature: -20°C to 150°C



STAINLESS STEEL BALL VALVES

Use as an ON-OFF valve for chemical products, water and pneumatic installations, gas, water, vacuum.

- Full flow monobloc design
- AISI 316 Stainless Steel
- PTFE seals
- Temperature limits: -20°C to 150°C
- Blow-out proof stem
- BSP Parallel Thread ISO 7/1Rp - DIN 2999

BSP	Bar	Part No.
1/4"	100	1-71969
3/8"	100	1-71970
1/2"	100	1-71971
3/4"	64	1-71972
1"	64	1-71973
1 1/4"	40	1-71974
1 1/2"	40	1-71975
2"	40	1-71976

Larger sizes to order

TOTAL BALL VALVE FF TEE HANDLE

Suitable for: gas & water distribution, industrial & domestic heating, hydraulics, oil, steam & vacuum.

- Full bore with perfect air bubble sealing
- No maintenance - equipped with wrapping seats ensuring long life cycles
- Four self-adjusting cone-shaped seals, with PTFE-PTFE sliding eliminating wear, form two sealing with automatic functioning
- An adjusting gland allows the sealing reset on the stem



BSP	Length	Part No.
1/8"	50mm	1-71689
1/4"	51mm	1-71690

Materials:

Body & threaded end:	Nickel plated Brass CW 617N
Gland & gland nut:	Nickel plated Brass CW 614N
Stem:	Brass CW 614N
Ball:	Chrome plated Brass CW 614N
Seals:	Pure PTFE (Teflon)
Tee Handle:	Black coated Aluminium UNI 5076
Fixing screw:	Zinc plated steel

Temperature Limits:
for fluids: -20°C to +130°C
for gas: -20°C to +60°C

Pressure Limits:
for fluids: 64 bar
for gas: PN4

BSP Thread: Female ISO7/1 (BS21)



BRASS SWING CHECK VALVE

- Integral metal seat and swing type disk for vertical or horizontal fixing
- Working temperature: 0°C to 90°C
- BSP Parallel Thread ISO 228 - DIN 259 - BS 2779

BSP	A	B	Bar*	PSI*	Part No
3/8"	43	50	12	170	1-71200
1/2"	44	50	12	170	1-71210
3/4"	53	58	12	170	1-71220
1"	63	67	12	170	1-71230
1 1/4"	72	77	10	140	1-71240
1 1/2"	82	88	10	140	1-71250
2"	95	101	10	140	1-71260
2 1/2"	119	130	8	110	1-71270
3"	133	150	8	110	1-71280
4"	168	185	8	110	1-71284

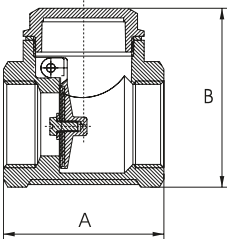

Bar* - Pressure Atmosphere kg/cm³ PSI* - LBS working pressure

PEGLER BRONZE SWING CHECK VALVE



- Integral metal seat and swing type disk for horizontal or vertical fixing (upward flow only)
- Body arrow indicates direction of flow
- Suitable for steam, water & oil
- BSP Taper Thread ISO7 - (BS21)
- Manufactured to BS 5154 PN25 Series B

BSP	A	B	Part No
1/4"	57	40	1-71299
3/8"	57	40	1-71300
1/2"	62	45	1-71301
3/4"	76	55	1-71302
1"	83	60	1-71303
1 1/4"	94	65	1-71304
1 1/2"	105	75	1-71305
2"	125	90	1-71306
3"	175	125	1-71308
4"	222	130	1-71309

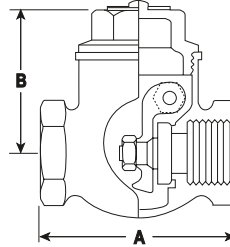

FOOT VALVE

- Case in brass with slotted base for water entry but not debris.
- Threaded BSP fitting to pipe or hose connectors
- G*/BSP Parallel Female Thread ISO 228/1 (BS2779)

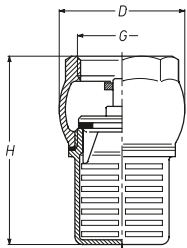

G*/BSP	H	D	Part No.
1/2"	61	40	1-74701
3/4"	70	45	1-74702
1"	82	51	1-74703
1 1/4"	95	62	1-74704
1 1/2"	103	69	1-74705
2"	121	80	1-74706
2 1/2"	137	100	1-74707
3"	173	121	1-74708

SPRING CHECK VALVE

- Suitable for hot water, oils, compressed air.
- Inline spring operated. Universal mounting
- Body: Hot pressed brass
- Stem Seat: Nylon/Glass Fibre
- Seat: Rubber GSCB/05-B
- Spring: 18/8 Stainless Steel
- BSP Parallel Female Thread ISO 228/1 (BS 2779)
- Working Temperature Max 110°C

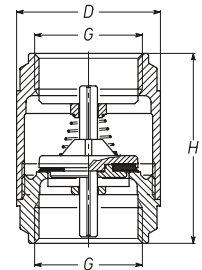

BSP	D	H	Part No.	Filter
3/8"	29	45	1-71400	
1/2"	30	48	1-71401	* 11-71411
3/4"	37	53	1-71402	* 11-71412
1"	44	59	1-71403	* 11-71413
1 1/4"	56	66	1-71404	
1 1/2"	63	71	1-71405	
2"	78	80	1-71406	
2 1/2"	103	93	1-71407	
3"	120	104	1-71408	

*S/S Filter available modifying to foot valve.

INLINE FILTER

- Nickel plated brass body with removable stainless steel filter.
- Easy to clean design with 800 micron mesh filter for water.
- 300 micron mesh for oil filter available to order & spare meshes available
- Ideal for hot & cold water
- Maximum working temperature: 100°C
- BSP Parallel Thread ISO 228 - DIN 259 - BS 2779

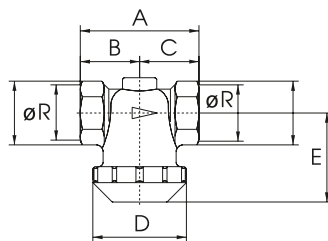

BSP	A	B	C	D	E	F	Bar*	PSI*	Part No.
3/8"	50	25	25	42	51	22	16	230	1-77100
1/2"	56	28	28	42	53	27	16	230	1-77101
3/4"	67	33	33	47	51	32	16	230	1-77102
1"	80	40	40	58	55	39	16	230	1-77103
1 1/4"	92	46	46	70	68	48	16	230	1-77104
1 1/2"	110	55	55	80	93	55	16	230	1-77105
2"	110	55	55	80	93	67	16	230	1-77106

Bar* - Pressure Atmosphere kg/cm³ PSI* - LBS working pressure

INLINE 'Y' TYPE STRAINER

- Cast brass body with hex ended threaded BSP parallel ports.
- Stainless steel filter gauze with perforations approx. 9 to Linear C.M.
- Filter removable through hex head cap
- G*/BSP Parallel Threads ISO 228/1 (BS 2779)

G*/BSP	H	L	Part No.
3/8"	40	55	1-77000
1/2"	40	58	1-77001
3/4"	50	70	1-77002
1"	60	87	1-77003
1 1/4"	68	96	1-77004
1 1/2"	75	106	1-77005
2"	90	126	1-77006

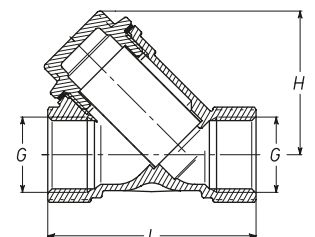

PEGLER BRONZE GLAND COCKS

- Traditional and reliable
- Accurately Ground Tapered plug ensuring pressure tightness
- Suitable for oil, water, steam
- Adjustable gland. Supplied with removable malleable iron lever
- **Technical:** Cast in Bronze
- **Ports:** Thread BSP Female
- **Rating:** 10 Bar 100°C.

Size	Part No.
1/4"	1-71169
3/8"	1-71170
1/2"	1-71171
3/4"	1-71172
1"	1-71173
1 1/4"	1-71174
3/8"	1-71180*

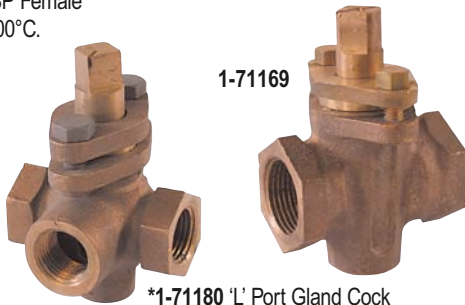

*1-71180 'L' Port Gland Cock



PRESTEX STOP TAP

- Compression ends for copper pipe.
- Kitemarked & manufactured to BS 1010

Size	Brass	DZR
15mm	1-52115B	1-52115
22mm	-	1-52122
28mm	-	1-52128



PRESTEX GATE VALVE

- Fullway with compression for copper pipe
- Kitemarked & manufactured to BS5154

Size	Brass	DZR
15mm	1-52015B	1-52015
22mm	1-52022B	1-52022
28mm	1-52028B	1-52028
35mm	-	1-52035
42mm	-	1-52042
54mm	-	1-52054

PUSH BUTTON VALVE

- Cast in brass with heavy S/S spring which keeps valve open when not depressed
- 3/8" BSP Parallel Female Threads ISO 228/1 (BS 2779)

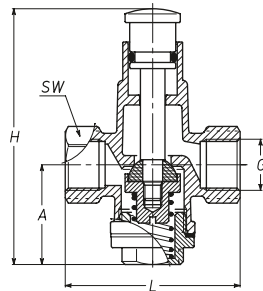

G/BSP	L	A	H	SW	Part No.
3/8"	57	32	85	22	1-71158

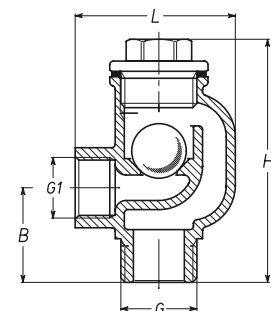

SYPHON BREAK VALVE

- Suitable for exhausts, engine inlet, water systems etc.
- Nickel plated brass body with neoprene ball and cap washer.
- G/BSP Parallel Thread ISO 228/1 (BS 2779)

G/BSP	G1	H	L	B	Part No.
1/2"	3/8"	68	44	26	1-71159

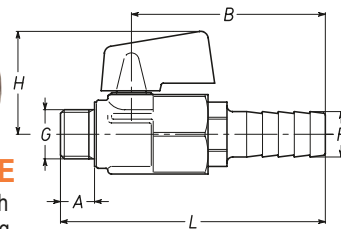
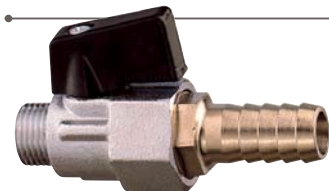

DRAIN COCK BALL VALVE

- Chrome plated brass ball valve with plastic lever allowing compact fitting.
- 1/4" BSP Male Parallel Thread ISO 228/1 (BS 2779)
- 1/2" hose barb

G/BSP	P	B	L	A	H	Part No.
1/4"	12	52	71	9	29	1-71156



DRAIN COCKS

- Male Taper Thread to BS21
- Type A to BS 2879/2
- Pressure/Temp rating 20 bar at 120° (max working)

Description	Part No.
1/2" Brass Type B	1-71152
1/2" Bronze Type A	1-71153
3/4" Brass Type B	1-71154

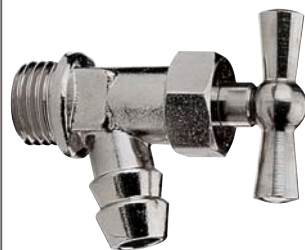

DRAIN COCK

- Chrome plated brass 1/4" BSP
- 3/8" ID Hose connection
- T handle operated
- Max Working Temperature: 80°C

G/BSP	A	B	C	Bar*	PSI*	Part No.
1/4"	43	30	35	20	280	1-71155

Bar* - Pressure Atmosphere kg/cm³ PSI* - LBS working pressure

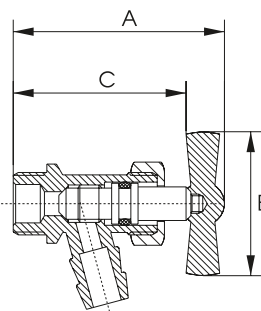

DRAIN COCK

- Solid brass
- Needle valve action by knurled knob opening 2mm dia. vent/outlet
- 16mm 1/8" BSP male parallel

Length Closed	Length Open	Part No.
31mm	35mm	1-71157



PEGLER FULL BORE GATE VALVES (BS 5154B)

- Non rising stem
- High quality lubricated packing in the gland which may be re-packed under pressure with valve fully open
- Kitemarked BS 5154
- Pressure Limit: PN20
- Suitable for steam, water and oil

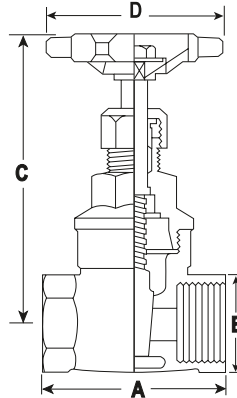

BSP	A	B	C	D	Bronze Parallel	Bronze Taper
3/8"	43	27	85	60	1-71000	-
1/2"	52	28	85	60	1-71001	1-71021
3/4"	56	34	95	60	1-71002	1-71022
1"	65	42	110	70	1-71003	1-71023
1 1/4"	73	50	125	75	1-71004	1-71024
1 1/2"	76	58	145	95	1-71005	1-71025
2"	90	72	170	105	1-71006	1-71026
2 1/2"	102	89	205	120	1-71007	1-71027
3"	114	100	240	155	1-71008	-

Specification	Bronze Model
Body	Bronze
Bonnet	Brass
Stem	Brass
Gland & Nut	Bras
Handle	Aluminium
Parallel Thread	ISO 228 (BS 2779)
Taper Thread	ISO 7 (BS 21)

WHEEL HANDLES

For gate valves

- Red plastic coated alloy
- Square tapered socket. (W12 Iron). Approx. sizes.



Square	O.Dia.	Type	Part No.
6mm	55mm	W1	1-71031
7mm	65mm	W3	1-71032
7mm	70mm	W4	1-71033
8mm	80mm	W5	1-71034
9mm	90mm	W6	1-71035
10mm	100mm	W7	1-71036
11mm	115mm	W8	1-71037
13mm	130mm	W10	1-71038
14mm	175mm	W12	1-71039

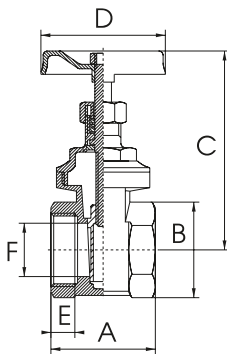

BRASS GATE VALVES

Suitable for industrial & hydraulic installations. Ideal for hot/cold water & different oils.

Technical Specifications:

BSP Parallel Thread - ISO 228, BS 2779, DIN 259

Bar* - Pressure Atmosphere kg/cm²

PSI* - LBS working pressure

Working Temperatures:

Air: -15°C to 105°C

Water: 0°C to 125°C

BSP	A	B	C	D	E	F	Bar*	PSI*	Part No.
1/4"	33	25	67	45	8	11	20	290	1-71490
1/2"	43	30	68	45	10	15	20	290	1-71510
3/4"	46	36	78	45	11	19	20	290	1-71520
1"	52	44	93	50	13	24	20	290	1-71530
1 1/4"	58	54	108	55	14	32	20	290	1-71540
1 1/2"	59	62	125	60	14	37	20	290	1-71550
2"	67	76	143	70	16	48	20	290	1-71560
2 1/2"	73	93	175	100	17	58	16	230	1-71570
3"	84	107	205	100	19	72	16	230	1-71580
4"	98	140	235	120	22	91	16	230	1-71584

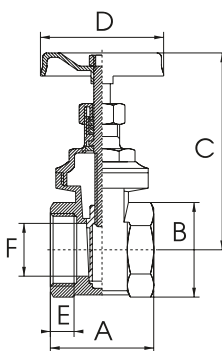

BRONZE GATE VALVES

Suitable for industrial & hydraulic installations. Ideal for hot/cold water & different oils.

Technical Specifications:

BSP Parallel Thread - ISO 228, BS 2779, DIN 259

Bar* - Pressure Atmosphere kg/cm²

PSI* - LBS working pressure

Working Temperatures:

Air: -15°C to 105°C

Water: 0°C to 125°C

BSP	A	B	C	D	E	F	Bar*	PSI*	Part No.
1/4"	36	-	66	45	8	11	-	-	1-71590
3/8"	38	25	66	45	9	13	16	230	1-71600
1/2"	38	25	68	45	9	15	16	230	1-71610
3/4"	45	36	78	45	10	19	16	230	1-71620
1"	48	43	90	50	11	24	16	230	1-71630
1 1/4"	51	54	108	55	11	32	16	230	1-71640
1 1/2"	57	62	122	60	13	37	16	230	1-71650
2"	61	76	125	70	13	47	16	230	1-71660
2 1/2"	76	95	175	100	16	60	16	230	1-71670
3"	80	112	205	100	16	72	16	230	1-71680
4"	96	140	235	120	19	93	16	230	1-71684

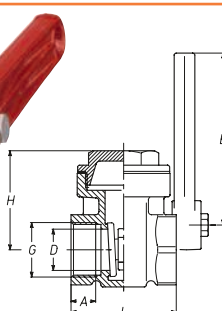
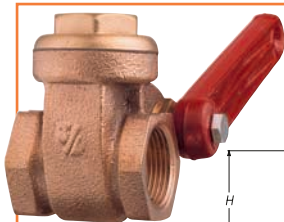

BRONZE LEVER GATE VALVES

- Quick closing gate valve
- 1/4 Turn of a lever opens solid wedge
- Suitable for oil and water
- Bronze body with S/S spindle
- Painted alloy lever
- G/BSP* Parallel Thread: ISO 228/1 BS 2779

G/BSP*	A	D	L	H	B	Part No.
1/2"	13	15	46	40	80	1-71771
3/4"	14	20	51	48	100	1-71772
1"	16	25	57	55	100	1-71773
1 1/4"	17	32	61	62	120	1-71774
1 1/2"	19	37	67	68	136	1-71775
2"	20	47	77	81	165	1-71776
3"	21	72	91	121	205	1-71778
4"	24	92	102	148	255	1-71779

BRONZE HOSE CONNECTORS



HOSE CONNECTOR

- Cast in Bronze with hex shoulder and serrated tail
- BSP Parallel Male Thread

STRAIGHT TYPE		
BSP	Hose	Part No.
1/2"	1/2"	1-72111
3/4"	3/4"	1-72112
1"	1"	1-72113
1 1/4"	1 1/4"	1-72114
1 1/2"	1 1/2"	1-72115
2"	2"	1-72116
2 1/2"	2 1/2"	1-72117
3"	3"	1-72118
4"	4"	1-72119

90 DEGREE BEND TYPE		
BSP	Hose	Part No.
1/2"	1/2"	1-72131
3/4"	3/4"	1-72132*
1"	1"	1-72133*
1 1/4"	1 1/4"	1-72134*
1 1/2"	1 1/2"	1-72135*
2"	2"	1-72136

* Available with NPT Thread
- ask for details



CAP & TAIL HOSE CONNECTOR

- Cast in Bronze, with hex. nut* & loose serrated tail including rubber washer
- BSP Parallel Female Thread

STRAIGHT TYPE		
BSP	Hose	Part No.
1/2"	1/2"	1-72121
3/4"	3/4"	1-72122
1"	1"	1-72123
1 1/4"	1 1/4"	1-72124
1 1/2"	1 1/2"	1-72125
2"	2"	1-72126
2 1/2"	2 1/2"	1-72127
3"	3"	1-72128

90 DEGREE BEND TYPE		
BSP	Hose	Part No.
1/2"	1/2"	1-72141
3/4"	3/4"	1-72142
1"	1"	1-72143
1 1/4"	1 1/4"	1-72144
1 1/2"	1 1/2"	1-72145
2"	2"	1-72146
2 1/2"	2 1/2"	1-72147
3"	3"	1-72148

* (up to 2") and lugged nut (2 1/2", 3")

BRONZE HOSE CONNECTORS

- BSP Taper Male Thread Hex Shoulder

BSP	Hose ID mm	Part No.
1/2"	13	1-78810
1/2"	16	1-78812
1/2"	19	1-78813
3/4"	16	1-78815
3/4"	19	1-78820
3/4"	25	1-78823
1"	25	1-78830
1"	32	1-78833
1 1/4"	32	1-78840
1 1/4"	38	1-78843

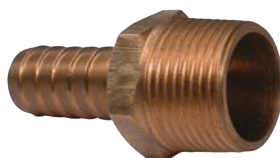

BSP	Hose ID mm	Part No.
1 1/2"	38	1-78850
1 1/2"	45	1-78853
1 1/2"	50	1-78855
2"	50	1-78860
2"	60	1-78866

BRASS HOSE CONNECTORS



90° HOSE CONNECTOR

- 90 Degree full bore
- Hot stamped in DZR Brass
- BSP Parallel Male Thread

BSP	Hose	Part No.
1/2"	3/4"	1-76801
3/4"	1"	1-76802
1"	1 1/4"	1-76803
1 1/4"	1 1/2"	1-76804



90° HOSE CONNECTOR

- 90 Degree full bore
- Hot stamped in DZR Brass
- BSP Parallel Female Thread

BSP	Hose	Part No.
3/8"	1/2"	1-76820
1/2"	3/4"	1-76821
3/4"	1"	1-76822
1"	1 1/4"	1-76823
1"	1 1/2"	1-76824



45° HOSE CONNECTOR

- 45 Degree full bore
- Hot stamped in DZR Brass
- BSP Parallel Male Thread

BSP	Hose	Part No.
1/2"	3/4"	1-76811
3/4"	1"	1-76812
1"	1 1/4"	1-76813
1 1/4"	1 1/2"	1-76814



LUG UNION

- Wing nut type
- DZR Brass
- BSP Parallel Male Thread

BSP	Hose ID	Part No.
3/8"	3/8"	1-76300
1/2"	1/2"	1-76301
3/4"	3/4"	1-76302
1"	1"	1-76303
1 1/4"	1 1/4"	1-76304
1 1/2"	1 1/2"	1-76305
2"	2"	1-76306
2 1/2"	2 1/2"	1-76307
3"	3"	1-76308



LUG UNION

- Loose wing nut type
- Brass: 1/4" - 3/4"
- DZR: 1" - 3"
- BSP Parallel Female Thread

BSP	Hose ID	Part No.
1/4"	1/4"	1-76190
3/8"	1/4"	1-76198
3/8"	3/8"	1-76200
1/2"	1/4"	1-76207
1/2"	3/8"	1-76209
1/2"	1/2"	1-76210
5/8"	3/8"	1-76214
3/4"	3/8"	1-76216
3/4"	1/2"	1-76218
3/4"	3/4"	1-76220



90° LUG UNION

- 90° Degree loose wing nut type
- DZR Brass
- BSP Parallel Female Thread

BSP(F)	Hose ID	Part No.
1/2"	1/2"	1-76310
3/4"	3/8"	1-76316
3/4"	1/2"	1-76318
3/4"	3/4"	1-76319

1"	1/2"	1-76226
1"	3/4"	1-76228
1"	1"	1-76230
1 1/4"	1"	1-76233
1 1/4"	1 1/4"	1-76240
1 1/2"	1 1/4"	1-76248
1 1/2"	1 1/2"	1-76250
2"	2"	1-76260
2 1/2"	2"	1-76265
3"	3"	1-76280

HOSE CONNECTOR

NPT thread hose connectors may be available to order

FOR MORE BRASS HOSE CONNECTORS SEE PAGE 12

BRONZE PIPE FITTINGS *NOT AVAILABLE AT PRESENT



90° ELBOW (FxF)

- BSP Parallel Female Threads

BSP	Radius	Part No.
½"	25	1-78111
¾"	35	1-78112
1"	40	1-78113
1¼"	50	1-78114
1½"	50	1-78115
2"	65	1-78116
2½"	80	1-78117
3"	120	1-78118*
4"	130	1-78119*



90° ELBOW (MxF)

- BSP Parallel Female Thread
 - BSP Male Thread
- Taper: ½" - 2"
Parallel: 2½" - 4"

BSP	Radius	Part No.
½"	25	1-78131
¾"	35	1-78132
1"	40	1-78133
1¼"	50	1-78134
1½"	50	1-78135
2"	65	1-78136
2½"	80	1-78137
3"	120	1-78138*
4"	130	1-78139*



EQUAL TEE (FxFxF)

- BSP Parallel Female Threads

BSP	Part No.
½"	1-78151
¾"	1-78152
1"	1-78153
1¼"	1-78154*
1½"	1-78155*
2"	1-78156*
2½"	1-78157*
3"	1-78158*
4"	1-78159*



EQUAL SOCKET (FxF)

- BSP Parallel Female Threads

BSP	Part No.
½"	1-78171
¾"	1-78172
1"	1-78173
1¼"	1-78174
1½"	1-78175
2"	1-78176
2½"	1-78177



REDUCING SOCKET (FxF)

- F x F Taper

BSP	Part No.
¾" x ½"	1-72151
1" x ¾"	1-72152
1" x ½"	1-72153
1¼" x 1"	1-72154
1½" x 1"	1-72155
1½" x 1¼"	1-72156
2" x 1½"	1-72157



PLUG

- BSP Taper Male Thread

BSP	Part No.
½"	1-78251
¾"	1-78252
1"	1-78253
1¼"	1-78254
1½"	1-78255
2"	1-78256
2½"	-



HEX BUSH

- BSP Parallel Female Thread ISO 7/1Rp (BS21)
- BSP Taper Male Thread ISO 7/1R (BS21)

BSP	BSP	Part No.
½" x ¼"		1-78269*
½" x ⅜"		1-78270
⅝" x ⅝"		1-78271*
¾" x ¼"		1-78272*
¾" x ⅝"		1-78273
¾" x ½"		1-78274
1" x ⅝"		1-78275
1" x ½"		1-78276
1" x ¾"		1-78277
1¼" x ¾"		1-78279
1¼" x 1"		1-78280
1½" x ¾"		1-78282*
1½" x 1"		1-78283
1½" x 1¼"		1-78284
2" x 1¼"		1-78287
2" x 1½"		1-78288
2½" x 2"		1-78289*
3" x 2½"		1-78291*
4" x 3"		1-78293*



FLANGED BACK NUT

- Heavy Duty Wide flanged

BSP	Flange Dia.	Part No.
½"	36mm	1-70131
¾"	50mm	1-70132
1"	58mm	1-70133
1¼"	64mm	1-70134
1½"	75mm	1-70135
2"	90mm	1-70136
2½"	112mm	1-70137
3"	129mm	1-70138
4"	169mm	1-70139



BLANKING CAP & CHAIN

- Cast Bronze cap with lugs and brass chain and nitrile washer

BSP	Part No.
½"	1-72161
¾"	1-72162
1"	1-72163
1¼"	1-72164
1½"	1-72165
2"	1-72166
2½"	1-72167
3"	1-72168
4"	1-72169



EQUAL HEX NIPPLE

- BSP Male Thread
- Taper: up to & inc 2"
ISO 7/1 (BS21)
- Parallel: 2½" & over
228/1 (BS2779)

BSP	Part No.
½"	1-78211
¾"	1-78212
1"	1-78213
1¼"	1-78214
1½"	1-78215
2"	1-78216
2½"	1-78217*
3"	1-78218*
4"	1-78219*

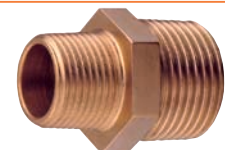

UNEQUAL HEX NIPPLE

- BSP Taper Male Thread ISO 7/1 (BS21)

BSP	Part No.
½" ⅝"	1-78231
¾" ½"	1-78232
1" ¾"	1-78233
1¼" 1"	1-78234
1½" 1¼"	1-78235
2" 1½"	1-78236
2½" 2"	-
3" 2½"	-
4" 3"	-

FOR STANDARD WEIGHT BRONZE BACK NUTS SEE PAGE 15

BRASS HOSE CONNECTORS



HOSE CONNECTOR

- BSP Taper Male Thread
- Straight with hex shoulder
- Brass: 1/8" - 3/8"
- DZR: 1/2" - 2 1/2"
- Some sizes are available with NPT Threads to special order

BSP(T)	Hose ID	Part No.
1/8"	1/8"	1-75980
1/8"	3/16"	1-75981
1/8"	1/4"	1-75983
1/8"	5/16"	1-75984
1/8"	3/8"	1-75985
1/8"	1/2"	1-75986
1/4"	1/8"	1-75988
1/4"	3/16"	1-75989
1/4"	1/4"	1-75990
1/4"	5/16"	1-75991
1/4"	3/8"	1-75993
1/4"	1/2"	1-75994
1/4"	5/8"	1-75995
3/8"	1/8"	1-75996
3/8"	1/4"	1-75998
3/8"	5/16"	1-75999
3/8"	3/8"	1-76000
3/8"	1/2"	1-76003
3/8"	5/8"	1-76004
3/8"	3/4"	1-76005

1/2"	3/8"	1-76009
1/2"	1/2"	1-76010
1/2"	5/8"	1-76012
1/2"	3/4"	1-76013
1/2"	1"	1-76015
3/4"	3/8"	1-76016
3/4"	1/2"	1-76018
3/4"	5/8"	1-76019
3/4"	3/4"	1-76020
3/4"	1"	1-76023
1"	1/2"	1-76026
1"	3/4"	1-76028
1"	1"	1-76030
1"	1 1/4"	1-76033
1"	1 1/2"	1-76034*
1 1/4"	3/4"	1-76036
1 1/4"	1"	1-76038
1 1/4"	1 1/4"	1-76040
1 1/4"	1 1/2"	1-76043
1 1/2"	1"	1-76046
1 1/2"	1 1/4"	1-76048
1 1/2"	1 1/2"	1-76050
1 1/2"	2"	1-76053
2"	2"	1-76060
2"	60mm	1-76062
2"	2 1/2"	1-76063
2 1/2"	2 1/2"	1-76070



HOSE CONNECTOR

- BSP Parallel Female Thread
- Straight with hex shoulder
- Brass: 1/8" - 3/4"
- DZR: 1" - 1 1/2"

BSP	Hose ID	Part No.
1/8"	1/4"	1-76083
1/8"	5/16"	1-76084
1/8"	3/8"	1-76085
1/4"	1/4"	1-76090
1/4"	5/16"	1-76091
1/4"	3/8"	1-76093
1/4"	1/2"	1-76094
3/8"	1/4"	1-76098
3/8"	5/16"	1-76099
3/8"	3/8"	1-76100
3/8"	1/2"	1-76103
3/8"	5/8"	1-76104
1/2"	1/4"	1-76107
1/2"	5/16"	1-76108
1/2"	3/8"	1-76109
1/2"	1/2"	1-76110
1/2"	5/8"	1-76112
1/2"	3/4"	1-76113
3/4"	5/8"	1-76119
3/4"	3/4"	1-76120
3/4"	7/8"	1-76121
3/4"	1"	1-76123

1"	5/8"	1-76127
1"	3/4"	1-76128
1"	1"	1-76130
1"	1 1/4"	1-76133
1"	1 1/2"	1-76135
1 1/4"	1"	1-76138
1 1/4"	1 1/4"	1-76140
1 1/4"	1 1/2"	1-76143
1 1/2"	1 1/4"	1-76148
1 1/2"	1 1/2"	1-76150
1 1/2"	2"	1-76153

90° HOSE CONNECTOR



HOSE CONNECTOR

- BSP Parallel Male Thread
- Straight with hex shoulder
- Brass

BSP	Hose ID	Part No.
1/8"	6mm	1-71986
1/8"	8mm	1-71988
1/4"	6mm	1-71990
1/4"	10mm	1-71993
3/8"	10mm	1-72000
3/8"	13mm	1-72003
3/8"	15mm	1-72005
1/2"	14mm	1-72010
1/2"	16mm	1-72012
1/2"	20mm	1-72013
1/2"	22mm	1-72014
3/4"	16mm	1-72015
3/4"	19mm	1-72020
3/4"	22mm	1-72022
3/4"	25mm	1-72023
3/4"	28mm	1-72028
1"	25mm	1-72030
1"	28mm	1-72031
1"	32mm	1-72033
1 1/4"	32mm	1-72040
1 1/4"	35mm	1-72042
1 1/4"	38mm	1-72043
1 1/4"	45mm	1-72045
1 1/2"	38mm	1-72050
1 1/2"	40mm	1-72051
1 1/2"	45mm	1-72053
1 1/2"	50mm	1-72055
2"	45mm	1-72058
2"	50mm	1-72060
2"	55mm	1-72064
2"	60mm	1-72066
2 1/2"	60mm	1-72076
2 1/2"	63mm	1-72070
2 1/2"	70mm	1-72077
3"	76mm	1-72080
3"	80mm	1-72088
4"	100mm	1-72090

- 90 Degree full bore
- Brass with hex shoulder
- BSP Parallel Male Thread

BSP	Hose ID	Part No.
3/8"	15mm	1-72100
1/2"	20mm	1-72101
3/4"	25mm	1-72102
1"	30mm	1-72103
1 1/4"	40mm	1-72104



HOSE CONNECTOR

- BSP Parallel Female Thread
- Straight with hex shoulder
- Brass

BSP	Hose ID	Part No.
1/8"	12mm	1-72387
1/4"	10mm	1-72396
1/4"	13mm	1-72397
3/8"	13mm	1-72400
3/8"	15mm	1-72405
1/2"	13mm	1-72410
1/2"	15mm	1-72411
1/2"	20mm	1-72413
3/4"	20mm	1-72420
3/4"	25mm	1-72425
1"	25mm	1-72430
1"	30mm	1-72435
1 1/4"	32mm	1-72440
1 1/4"	35mm	1-72443
1 1/4"	40mm	1-72445
1 1/2"	40mm	1-72450
1 1/2"	45mm	1-72453
1 1/2"	50mm	1-72455
2"	50mm	1-72460
2 1/2"	70mm	1-72477
3"	80mm	1-72482



HOSE CONNECTOR

- Competitively priced
- Shell moulded in Brass
- With flanged hex shoulder
- BSP Parallel Male Thread

BSP	Hose ID	Part No.
1/4"	6mm	1-77999
3/8"	10mm	1-78000
1/2"	13mm	1-78001
3/4"	20mm	1-78002
1"	25mm	1-78003
1 1/4"	32mm	1-78004
1 1/2"	38mm	1-78005
2"	50mm	1-78006

SPECIAL HOSE CONNECTORS

- Brass
- Popular on engines.



Thread	Hose ID	Part No.
M14 x 1.5	5/8"	1-77212
M22 x 1.5	1/2"	1-77222
M14 x 1.5	1/2"	1-77210

* Short

BRASS PIPE FITTINGS (CW617N)



90° SWEPT BEND (FxF)

- BSP Parallel Female Threads

BSP	Radius	Part No.
3/8"	35	1-72690
1/2"	40	1-72691
3/4"	55	1-72692
1"	70	1-72693
1 1/4"	90	1-72694
1 1/2"	100	1-72695
2"	125	1-72696



90° SWEPT BEND (MxF)

- BSP Parallel Female Thread
- BSP Taper Male Thread

BSP	Radius	Part No.
3/8"	35	1-72700
1/2"	40	1-72701
3/4"	55	1-72702
1"	70	1-72703
1 1/4"	90	1-72704
1 1/2"	100	1-72705
2"	125	1-72706



45° ELBOW (FxF)

- BSP Parallel Female Threads

BSP	Part No.
1/2"	1-72711
3/4"	1-72712
1"	1-72713
1 1/4"	1-72714
1 1/2"	1-72715
2"	1-72716



45° ELBOW (MxF)

- BSP Parallel Female Thread
- BSP Taper Male Thread

BSP	Part No.
1/2"	1-72771
3/4"	1-72772
1"	1-72773
1 1/4"	1-72774
1 1/2"	1-72775
2"	1-72776



90° ELBOW (FxF)

- BSP Parallel Female Threads

BSP	Radius	Part No.
1/8"	8	1-72488
1/4"	15	1-72490
3/8"	20	1-72500
1/2"	25	1-72510
3/4"	35	1-72520
1"	40	1-72530
1 1/4"	50	1-72540
1 1/2"	50	1-72550
2"	65	1-72560
2 1/2"	80	1-72570
3"	120	1-72580
4"	130	1-72584



90° ELBOW (MxF)

- BSP Parallel Female Thread
 - BSP Male Thread
- Taper: 1/8" - 2" Parallel: 2 1/2" - 4"

BSP	Radius	Part No.
1/8"	8	1-72588
1/4"	15	1-72590
3/8"	20	1-72600
1/2"	25	1-72610
3/4"	35	1-72620
1"	40	1-72630
1 1/4"	50	1-72640
1 1/2"	50	1-72650
2"	65	1-72660
2 1/2"	80	1-72670
3"	120	1-72680
4"	130	1-72684



REDUCING SOCKET (FxF)

- BSP Parallel Female Thread

BSP	Part No.
3/8" x 1/8"	1-72969
3/8" x 1/4"	1-72970
1/2" x 1/4"	1-72971
1/2" x 3/8"	1-72972
3/4" x 3/8"	1-72973
3/4" x 1/2"	1-72974
1" x 1/2"	1-72975
1" x 3/4"	1-72976
1 1/4" x 3/4"	1-72977
1 1/4" x 1"	1-72978
1 1/2" x 1"	1-72979
1 1/2" x 1 1/4"	1-72980
2" x 1 1/4"	1-72981
2" x 1 1/2"	1-72982



EQUAL SOCKET (FxF)

- BSP Parallel Female Thread

BSP	Part No.
1/8"	1-72898
1/4"	1-72899
3/8"	1-72900
1/2"	1-72901
3/4"	1-72902
1"	1-72903
1 1/4"	1-72904
1 1/2"	1-72905
2"	1-72906
2 1/2"	1-72907



CROSS (FEMALE)

- BSP Parallel Female Threads

BSP	Part No.
3/8"	1-72780
1/2"	1-72781
3/4"	1-72782
1"	1-72783
1 1/4"	1-72784
1 1/2"	1-72785
2"	1-72786



Y CONNECTOR

- 3 way Female Y Connector
- BSP Parallel Female Threads

BSP	Part No.
3/8"	1-78010
1/2"	1-78011



EQUAL TEE (FxFxF)

- BSP Parallel Female Thread

BSP	Part No.
1/8"	1-72788
1/4"	1-72790
3/8"	1-72800
1/2"	1-72810
3/4"	1-72820
1"	1-72830
1 1/4"	1-72840
1 1/2"	1-72850
2"	1-72860
2 1/2"	1-72870
3"	1-72880
4"	1-72884

BRASS & DZR PIPE FITTINGS



HEX BUSH

- BSP Male Thread
Taper: up to 2" Parallel: over 2"
- BSP Parallel Female Thread

Male	x Female	Part No.
1/4"	x 1/8"	1-73170
3/8"	x 1/8"	1-73175
3/8"	x 1/4"	1-73180
1/2"	x 1/4"	1-73190
1/2"	x 3/8"	1-73200
5/8"	x 3/8"	1-73204
3/4"	x 1/4"	1-73206
3/4"	x 3/8"	1-73208
3/4"	x 1/2"	1-73210
1"	x 3/8"	1-73215
1"	x 1/2"	1-73220
1"	x 3/4"	1-73230
1 1/4"	x 3/4"	1-73240
1 1/4"	x 1"	1-73250
1 1/2"	x 3/4"	1-73255
1 1/2"	x 1"	1-73260
1 1/2"	x 1 1/4"	1-73270
2"	x 1 1/4"	1-73275
2"	x 1 1/2"	1-73280
2 1/2"	x 2"	1-73290
3"	x 2 1/2"	1-73295
4"	x 3"	1-73297



DZR NIPPLE

- BSP Parallel Threads

Female	Male	Part No.
1/4"	1/8"	1-76900
3/8"	1/8"	1-76901
3/8"	1/4"	1-76904
1/2"	1/8"	1-76908
1/2"	1/4"	1-76909
1/2"	3/8"	1-76910
3/4"	1/4"	1-76919
3/4"	3/8"	1-76920
3/4"	1/2"	1-76921
1"	3/8"	1-76930
1"	1/2"	1-76931
1"	3/4"	1-76932
1 1/4"	3/8"	1-76940
1 1/4"	1/2"	1-76941
1 1/4"	3/4"	1-76942
1 1/4"	1"	1-76943
1 1/2"	1/2"	1-76951
1 1/2"	3/4"	1-76952
1 1/2"	1"	1-76953
1 1/2"	1 1/4"	1-76954
2"	1"	1-76963
2"	1 1/4"	1-76964
2"	1 1/2"	1-76965
2 1/2"	2"	1-76976



EQUAL HEX NIPPLE

- BSP Male Thread
Taper: up to & inc. 2"
Parallel: 2 1/2" & over

BSP	Thread	Part No.
1/8"	10mm	1-72988
1/4"	12mm	1-72990
3/8"	14mm	1-73000
1/2"	16mm	1-73010
3/4"	18mm	1-73020
1"	20mm	1-73030
1 1/4"	21mm	1-73040
1 1/2"	24mm	1-73050
2"	25mm	1-73060
2 1/2"	26mm	1-73070
3"	26mm	1-73080
4"	28mm	1-73084



UNEQUAL HEX NIPPLE

- BSP Male Thread
Taper: up to 1" x 3/4"
Parallel: 1 1/4" x 1" & over

BSP		Part No.
1/4"	1/8"	1-73999
3/8"	1/4"	1-74000
1/2"	3/8"	1-74001
3/4"	1/2"	1-74002
1"	3/4"	1-74003
1 1/4"	1"	1-74004
1 1/2"	1 1/4"	1-74005
2"	1 1/2"	1-74006
2 1/2"	2"	1-74007
3"	2 1/2"	1-74008
4"	3"	1-74009



NIPPLE

- BSP Parallel External Thread

BSP	Length	Part No.
1/4"	20mm	1-73099
3/8"	25mm	1-73100
1/2"	30mm	1-73101
3/4"	30mm	1-73102
1"	33mm	1-73103
1 1/4"	40mm	1-73104
1 1/2"	45mm	1-73105
2"	50mm	1-73106



DZR RUNNING NIPPLE

- BSP Parallel External Thread

BSP	Length	Part No.
3/8"	100mm	1-76410
1/2"	100mm	1-76411
3/4"	100mm	1-76412
1"	100mm	1-76413
1 1/4"	150mm	1-76414
1 1/2"	150mm	1-76415



BULKHEAD FITTING

By use of parallel threaded nipple you can with flanged backnuts (page 15) make bulkhead fitting to suit most applications.

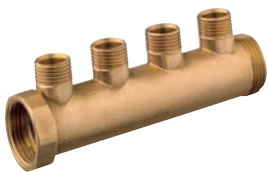

MANIFOLD MALE CONNECTIONS

- BSP Parallel Male Threads
- Available in two sizes each with either 3 or 4 spur take off outlets

BSP	Spurs	Part No.
3/4"	3 x 1/2"	1-78923
3/4"	4 x 1/2"	1-78924
1"	3 x 1/2"	1-78933
1"	4 x 1/2"	1-78934



MANIFOLD FEMALE CONNECTIONS

- BSP Parallel Female Threads
- Up to 12 spurs per size available

BSP	Spurs	Part No.
3/4"	2 x 1/2"	1-78940
3/4"	3 x 1/2"	1-78941
1"	2 x 1/2"	1-78950
1"	3 x 1/2"	1-78951
1"	5 x 1/2"	1-78953
1 1/4"	2 x 1/2"	1-78960
1 1/4"	3 x 1/2"	1-78961
1 1/4"	4 x 1/2"	1-78962
1 1/4"	5 x 1/2"	1-78963



BARREL NIPPLE

- Extended brass tube
- BSP Taper Male Thread
- Length O.A.100mm

BSP	Thread*	Part No.
1/2"	15mm	1-73111
3/4"	16mm	1-73112
1"	18mm	1-73113
1 1/4"	21mm	1-73114
1 1/2"	21mm	1-73115
2"	25mm	1-73116

* Length of thread at each end

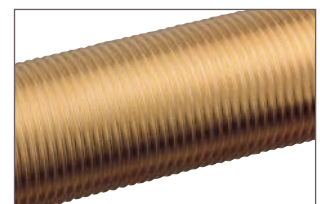

THREADED TUBE

- BSP Parallel External Thread
- Length 1000mm

BSP	Bore	Part No.
3/8"	11mm	1-73980
1/2"	15mm	1-73981
3/4"	19mm	1-73982
1"	25mm	1-73983
1 1/4"	34mm	1-73984
1 1/2"	40mm	1-73985
2"	50mm	1-73986

BRASS PIPE FITTINGS (CW617N)

TO ORDER ONLY



ELBOWED UNION (FxF)

- Female / Female
- Brass with tapered seat

BSP	Part No.
3/8"	1-74060
1/2"	1-74061
3/4"	1-74062
1"	1-74063
1 1/4"	1-74064
1 1/2"	1-74065
2"	1-74066

TO ORDER ONLY



ELBOWED UNION (MxF)

- Male / Female
- Brass with tapered seat

BSP	Part No.
3/8"	1-74070
1/2"	1-74071
3/4"	1-74072
1"	1-74073
1 1/4"	1-74074
1 1/2"	1-74075
2"	1-74076

TO ORDER ONLY



UNION (FxF)

- Female / Female
- Shell moulded in Brass, with tapered internal connection

BSP	Part No.
3/8"	1-74080
1/2"	1-74081
3/4"	1-74082
1"	1-74083
1 1/4"	1-74084
1 1/2"	1-74085
2"	1-74086

TO ORDER ONLY



UNION (MxF)

- Male / Female
- Shell moulded in Brass, with tapered internal connection

BSP	Part No.
3/8"	1-74090
1/2"	1-74091
3/4"	1-74092
1"	1-74093
1 1/4"	1-74094
1 1/2"	1-74095
2"	1-74096



CAP

- BSP Parallel Female Thread
- Brass with hex head

BSP	Part No.
1/8"	1-74368
1/4"	1-74369
3/8"	1-74370
1/2"	1-74371
3/4"	1-74372
1"	1-74373
1 1/4"	1-74374
1 1/2"	1-74375
2"	1-74376



PLUG

- BSP Taper Male Thread
- Brass with square head

BSP	Part No.
1/8"	1-74280
1/4"	1-74290
3/8"	1-74300
1/2"	1-74310
3/4"	1-74320
1"	1-74330
1 1/4"	1-74340
1 1/2"	1-74350
2"	1-74360
2 1/2"	1-74361



FLANGED PLUG

- Brass with hex. on top
- BSP Parallel Male Thread

BSP	Part No.
1/4"	1-74379
3/8"	1-74380
1/2"	1-74381
3/4"	1-74382
1"	1-74383
1 1/4"	1-74384
1 1/2"	1-74385
2"	1-74386
2 1/4"	1-743865



WASHERS

- Sizes 3/8" - 1": Machined
- Sizes 1 1/4" - 4": Cast
- Thickness: 3-5mm

BSP	OD	ID	Part No.
1/2"	27	17	1-73410
3/8"	38	21	1-73411
3/4"	45	27	1-73412
1"	50	34	1-73413
1 1/4"	68	43	1-73414
1 1/2"	76	49	1-73415
2"	88	61	1-73416
2 1/2"	112	71	1-73417
3"	125	88	1-73418
4"	150	113	1-73419



HEX. LOCKNUTS

- Brass, BSP Thread

BSP	L/Weight Part No.	H/Weight Part No.
1/4"	-	1-73489
3/8"	1-73400	1-73490
1/2"	1-73401	1-73491
3/4"	1-73402	1-73492
1"	1-73403	1-73493
1 1/4"	1-73404	1-73494
1 1/2"	1-73405	1-73495
2"	1-73406	1-73496
2 1/2"	-	1-73497
3"	-	1-73498
4"	-	1-73499

FLANGED BACK NUTS

Available in wider flange diameters which we consider an important factor if on wood or GRP.



BSP	Flange Dia.	Part No.
3/8"	30mm	1-73300
1/2"	35mm	1-73301
3/4"	40mm	1-73302
1"	50mm	1-73303
1 1/4"	60mm	1-73304
1 1/2"	66mm	1-73305

WIDE FLANGED		
BSP	Flange Dia.	Part No.
1/2"	38mm	1-73311
3/4"	44mm	1-73312
1"	51mm	1-73313

STANDARD WEIGHT BRONZE BACK NUTS

BSP	Flange Dia.	Part No.
1/2"	40mm	12-70251-2
3/4"	46mm	12-70252-2
1"	58mm	12-70253-2
1 1/4"	68mm	12-70254-2
1 1/2"	76mm	12-70255-2
2"	90mm	12-70256-2
2 1/2"	110mm	12-70257-2
3"	122mm	12-70258-2
4"	150mm	12-70259-2

FOR BRONZE HEAVY DUTY WIDE FLANGED BACK NUTS SEE PAGE 12

KWICK-KAM COUPLINGS



KWICK-KAM COUPLINGS POLYPROPYLENE - GLASS-COUPLED POLYPROPYLENE

- A quick, simple and safe method of extending hoses
- Ideal for pump out machines
- BSP parallel flat seal undercut
- Handles & pins are 316 Stainless Steel
- Working pressure up to 8.5 Bar (125PSI)
- Standard seal EPDM/Polypropylene Alloy
- Interchangeable with other couplings of similar design to MIL-C-27487
- Alternative sizes available to order from 3/4" to 4"

3/4", 1", 1 1/2" POLY COUPLERS

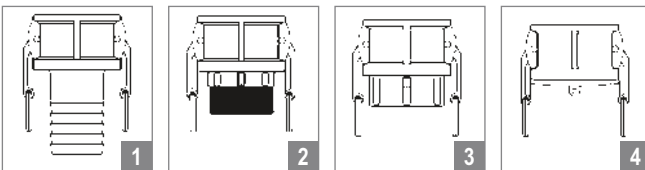

No.	Description	3/4" P/No.	1" P/No.	1 1/2" P/No.
1	Poly Coupler x Hose	1-76712	1-76713	1-76715
2	Poly Coupler x BSPM	1-76742	1-76743	1-76745
3	Poly Coupler x BSPF	1-76762	1-76763	1-76765
4	Poly Coupler x Dust Cap	1-76752	1-76753	1-76755

3/4", 1", 1 1/2" POLY ADAPTERS

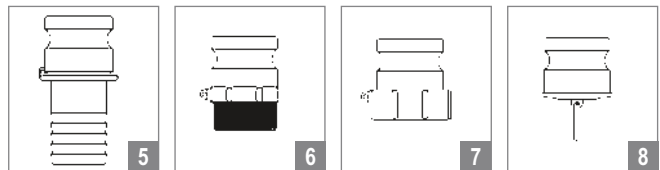

No.	Description	3/4" P/No.	1" P/No.	1 1/2" P/No.
5	Poly Adapter x Hose	1-76772	1-76773	1-76775
6	Poly Adapter x BSPM	1-76722	1-76723	1-76725
7	Poly Adapter x BSPF	1-76732	1-76733	1-76735
8	Poly Adapter x Dust Plug	1-76782	1-76783	1-76785

HOSES

STANDARD SUCTION & DELIVERY HOSE - 30m



Colour: Black (1/2" - 2"),
Translucent green with grey spiral (2 1/2" or 3").

Temperature Range:
-15°C / + 65°C

Description: Very flexible suction and delivery PVC hose, reinforced with a rigid PVC spiral, for light applications. Smooth inner and outer surface and good flexibility at low temperatures.

Applications: For general purposes in agriculture, marine, general and building industries. Suitable for deck drains, pump outlets and low suction inlets. Conveyance of liquids, granules, dust and powder.

Part No.	ID		Weight g/m	Burst Pressure Bar	Bend Radius mm	Wall mm
	Inch	mm				
1-90012	1/2"	12	150	32	64	2.5
1-90014	5/8"	16	180	27	76	2.6
1-90016	3/4"	19	230	24	102	2.9
1-90018	1"	25	310	22	127	3.1
1-90019	1 1/8"	28	320	See table below		
1-90020	1 1/4"	32	390	20	130	3.3
1-90022	1 1/2"	38	510	17	150	3.5
1-90028	2"	51	740	15	200	4.0
1-90032	2 1/2"	63	1100	10	260	4.4
1-90038	3"	76	1450	10	320	4.9

Larger sizes available to order.

Part No.	ID	Weight g/m	Vacuum m.H2O	Working Pressure
	Inch	mm		
1-90019*	1 1/8"	28	32	7 bar

* Temp range: -5°C + 35°C

MEDIUM SUCTION & DELIVERY HOSE - 30m



Colour: Olive green.

Temperature Range: -15°C / + 65°C
(cold bend -45°C)

Vacuum: 680mm Hg = 90% at 20°C

Description: Medium duty flexible suction/discharge PVC hose, reinforced with a rigid PVC spiral, for general purposes.

Applications: For all suction and pumping applications in agriculture, marine, chemicals, general and building industries. Conveyance of water, sludge, slurries & waste matter. Suitable for engine, bilge and deck wash pumps. Resistant to most oxidising and reducing agents and diluted acids and alkalis. For more detailed information contact Aquafax Sales Office.

Part No.	ID		Working Pressure		Bend Radius mm	Wall mm
	Inch	mm	PSI	Bar		
1-90052	1"	25	117	8	125	4.0
1-90054	1 1/4"	32	102	7	175	4.0
1-90056	1 1/2"	38	88	6	175	4.0
1-90058	2"	51	88	6	225	4.5
1-90060*	2 1/2"	63	73	5	305	5.0
1-90062*	3"	76	58	4	355	5.5

Burst Pressure: 3:1 Safety factor @ 20°C.

* TO ORDER ONLY. Plus Larger sizes available to order.

CLEAR UNREINFORCED PVC HOSE - 30m

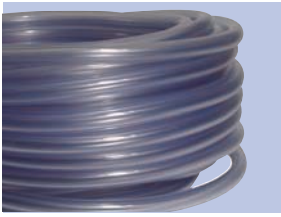

Features:

- Made from Cadmium free materials
- High resistance to acids/alkalis
- Silicone free
- Low toxicity - suitable for food use

Colour: Standard crystal clear.

Temperature Range: -15°C to +60°C

Description: Crystal clear, highly versatile, flexible unreinforced PVC hose for low pressure applications manufactured from PVC materials whose ingredients are FDA and BGA approved for food contact applications.

Applications: Conveying plating acids, and many other liquids including potable water. Also used as suds pipes and protection and decoration of metal tubes, wooden dowelling and yacht rigging. Under most conditions it is suitable for use with oils, greases & solvents.

Relationship of Bend Radius to Hose Diameter

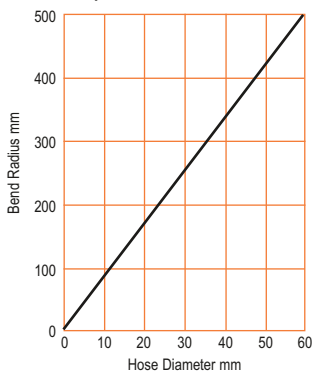

Part No.	ID Inch mm	OD mm
1-90203	3/16" 5	8
1-90204	1/4" 6	9
1-90207	5/16" 8	11
1-90208	5/16" 8	14
1-90210	1/4" 10	16
1-90211	1/2" 12	15
1-90212	1/2" 12	18
1-90213	1/2" 13	19
1-90216	5/8" 16	22
1-90219	3/4" 19	25
1-90222	7/8" 22	28
1-90225	1" 25	31
1-90233	1 1/4" 32	42
1-90238	1 1/2" 38	47
1-90250	2" 50	62

CLEAR REINFORCED PVC HOSE - 30m

Features:

- Made from Cadmium free materials
- High resistance to acids/alkalis
- Silicone free
- Low toxicity - suitable for food use
- Manufactured to comply with BS6066 & ISO5774

1-90304



Colour: Reinforced transparent

Temperature Range: -15°C to +60°C

Description: Industrial multi purpose and flexible PVC hose reinforced with a polyester fibre. All clear products are manufactured from PVC materials whose ingredients are all FDA, BGA and BIPRA approved for food contact applications. Good UV resistance.

Applications: Conveying many liquids and gases under pressure. Instrumentation, crop spraying and many other industrial applications. Conveyance of fluid and semi-fluid food stuffs.



1-90310R



1-90310B

Part No.	ID Inch mm	OD mm	Burst Pressure Bar	Bend Radius mm
1-90304	1/4" 6.3	11.5	64	28
1-90306	5/16" 8	13.5	64	29
1-90308	3/8" 10	16	60	40
1-90310*	1/2" 12.5	18.5	48	55
1-90312	5/8" 16	23	40	95
1-90314	3/4" 19	26	40	135
1-90316	1" 25	33	40	210
1-90318	1 1/4" 32	41	24	320
1-90320	1 1/2" 38	49	24	420
1-90322	2" 50	62	12	650

Burst Pressure:
4:1 Safety factor
@ 23°C + 3°C.

1/2" ID is available in red or blue.

*To order add R or B to Part No.
i.e. 1-90310R or 1-90310B

SANITATION HOSE - 40M

A premium rubber sanitation hose offering high resistance to odour permeation.



Hose Size			Working Pressure PSI BAR	Bend Radius mm	Weight kg/mtr	Coil Length mtr	Part No.
NOM Inch	ID mm	OD mm					
3/4	19	29	45 3	114	0.515	40	1-90112
1	25	36	45 3	150	0.681	40	1-90114
1 1/2	38	48	45 3	228	0.993	40	1-90118

Specification

Application:	Conveyance of effluent
Tube:	Black SBR rubber
Reinforcement:	Synthetic textile fabrics, steelwire helix between layers
Cover:	White, SBR/EPDM rubber
Temperature range:	-40°C to +70°C
Safety factor:	3-1
Branding:	W = Marine sanitation (not for potable water) white letters on blue stripe

SANITATION HOSE - 30m



Colour: White

Description: From experience in hoses suitable for toilet waste; this flexible nitrile/PVC blend with PVC spiral evolved. This forms an even greater barrier to odours permeating through the hose wall. Excellent resistance to chemicals and bacteriological growth. Smooth bore.

Part No.	ID Inch mm	Max Work Pressure @ 20°C Bar	Bend Radius mm	Wall mm	Vacuum MH20
1-90000	1/2" 12	32	64		2.5
1-90002	3/4" 19	5.5	110	2.9	2.9
1-90004	1" 25	21	127	3.4	3.1
1-90008	1 1/2" 38	16	150	3.8	3.5
1-90010	2" 51	14	200		4.0

LIGHTWEIGHT PVC DUCTING HOSE - 10m



Colour: Black

Temperature Range: -20°C to +75°C

Description: Flexible, light-duty ventilation and ducting hose, reinforced with a PVC covered steel spiral.

Applications: In ventilation systems and extraction of dust, powder, fumes and woodchip.

Part No.	ID Inch mm	Max Work Pressure @ 20°C Bar	Bend Radius mm	Vacuum MH20
1-90508*	2" 51	1.40	22	2.5
1-90510	2 1/4" 57	1.20	28	2.5
1-90512	2 1/2" 65	1.20	28	2.5
1-90514	3" 76	0.93	30	2.5
1-90518	3 1/2" 89	0.69	40	2.5
1-90520*	4" 102	0.55	50	2.5

* To order only

ALTERNATIVE COLOURS & SIZES
MAY BE AVAILABLE TO ORDER

FUEL HOSES TO: BS EN ISO 7840



TITAN FUEL HOSE ASSEMBLIES

BS EN ISO 7840 CLASS A1

These hoses completely meet the EC Recreational Craft Directive, which is a rarity, being tested by B.S.I. and given an EC type examination certificate by Lloyds register in order to **totally** comply with the regulation unlike many marketed. In most cases 'TITAN' greatly exceeded the test requirements.

Specification:

Special nitrile rubber inner metal braided and then sleeved to show specification. The ends have heavy copper extension spigots swaged in brass with hexagon collar for securing when fitting to compression fittings. 1/2" Size available to order.

Length	SPIGOT SIZE		
	1/4"	5/16"	3/8"
12"	1-57910	1-57920	1-57930
15"	1-57911	1-57921	1-57931
18"	1-57912	1-57922	1-57932
24"	1-57913	1-57923	1-57933
30"	1-57914	1-57924	1-57934
36"	1-57915	1-57925	1-57935
42"	1-57916	1-57926	1-57936

Test Requirement:		Titan Performance:
Burst Pressure Test:	1.36 Mpa	12.5 to 17.5 Mpa
Fire Test (about 750°C):	150 seconds	205 to 220 seconds
Fuel Permeation:	4g (m2h)	1.23 to 1.95 (m2h)

MARINE FUEL HOSE COILS

EN ISO 7840 A1 & A2

- Black fuel resistant NBR rubber tube
- Cover is abrasion, ozone, weather, and heat resistant
- Type A1 is also oil resistant
- Temperature range: -35°C to +100°C
- Type A2 is mandrell wound and also features twin steel wire helix reinforcement



Type	Hose Size			Working Pressure		Bend Radius mm	Weight kg/mtr	10m Coil	Long Coil
	NOM Inch	ID mm	OD mm	PSI	BAR				
A1	3/16	5	12	145	10	50	0.146	1-57799	1-57819 (100m)
A1	1/4	6	13	145	10	60	0.162	1-57800	1-57820 (100m)
A1	5/16	8	16	145	10	80	0.235	1-57801	1-57821 (100m)
A1	3/8	10	18	145	10	100	0.274	1-57802	1-57822 (100m)
A1	1/2	13	22	145	10	130	0.383	1-57803	1-57823 (100m)
A1	5/8	16	25	145	10	160	0.450	1-57804	1-57824 (50m)
A1	3/4	19	29	145	10	190	0.582	1-57805	1-57825 (50m)
A2	1	25	35	73	5	152	0.711	1-57806	1-57826 (40m)
A2	1 1/4	32	42	73	5	192	0.990	1-57807	1-57827 (40m)
A2	1 1/2	38	48	73	5	228	1.151	1-57808	1-57828 (30m)
A2	2	51	63	73	5	305	1.840	1-57809	1-57829 (30m)

Available in cut metre lengths (premium price).

Add 1 in front of large coils Part No. ie 11-57819 and state length required.

The difference between Type A1 and Type A2 is the fuel permeation rate in a test environment. Type A1 is hose tested with a permeation rate of 4g/m sq per hour or less.

Type A2 is hose tested with a permeation rate of 4g/m sq per hour up to and including 12g/m sq per hour.

COPPER AND NYLON TUBING



COPPER TUBING

COPPER TUBING

- Annealed soft copper tubing in 10m or 30m coils
- Manufactured to BS EN 12735-1:2001

Tube OD	Wall Thickness	Gauge	Working Pressure PSI	Part No.s	
				10m	30m
1/8"	.711mm	22	3026	1-50011	-
3/16"	.711mm	22	1978	1-50021	1-50023
1/4"	.914mm	20	1891	1-50031	1-50033
5/16"	.914mm	20	1513	1-50041	1-50043
3/8"	.914mm	20	1261	1-50051	1-50053
1/2"	.914mm	20	945	1-50061	1-50063
5/8"	1.8mm	16	742	1-50071	1-50073
3/4"	1.8mm	16	625	1-50081	1-50083



NYLON TUBING

Tube OD	Wall	PSI	10m	30m
4mm	0.6mm	1993	1-50111	-
5mm	0.8mm	2124	1-50121	-
6mm	1.0mm	2211	1-50131	1-50133
8mm	1.0mm	1658	1-50141	1-50143
10mm	1.0mm	1324	1-50151	1-50153
12mm	1.0mm	1091	1-50161	1-50163
15mm	1.0mm	1265	1-50171	1-50173

NYLON TUBING - 30m

- Flexible, natural colour
- Suitable for pneumatic, fuel and lubrication
- Working Temperature: -35°C to +70°C
- Sold in 30m coils

*Working Pressures: values given are based on the short-term burst pressure of nylon at 20°C using a safety factor of 4:1.

Tube OD	Tube ID	Pressure* PSI	Bar	Part No.
1/8"	.058"	700	48	1-51003
3/16"	.117"	450	31	1-51023
1/4"	.170"	370	25	1-51033
5/16"	.212"	370	25	1-51043
3/8"	.250"	400	27	1-51053
6mm	4mm	350	24	1-51115
8mm	5.5mm	335	23	1-51116
10mm	7mm	320	22	1-51117

OTHER SIZES TO ORDER

JCS 'P' CLIPS FOR PIPES, CABLES & HOSES

STAINLESS STEEL 'P' CLIPS

- Marine quality Stainless Steel clips with a TPE rubber liner
- TPE rubber liner absorbs vibration, stops water seeping into the clamped area & prevents damage to the pipe or cable
 - Special strengthening rib keeps clips flush with the surface
 - TPE liner is UV and ozone resistant
 - Elongated upper hole to help line up the bolt when fitting
 - Fixing nuts and bolts not supplied
 - Packed in bags of 25
 - Alternative rubber liners & non-standard size can be supplied to special order



Material Specification:

Stainless 'P' Clip: BS/AISI 304 - DIN 1.4301 - 18/8 Stainless Steel
Liner: TPE rubber (black)
 - 65 IRHD hardness
 Service Temp -30°C to + 50°C

Int. Dia.	A	B	C	Part No
5mm	6	15	0.7	1-88405
6mm	7	16	0.7	1-88406
8mm	8	17	0.7	1-88408
9mm	8	18	0.7	1-88409
10mm	9	18	0.7	1-88410
12mm	10	20	0.7	1-88412
13mm	10	20	0.9	1-88413
16mm	12	21	0.9	1-88416
19mm	13	23	0.9	1-88419
21mm	15	24	0.9	1-88421
22mm	15	25	0.9	1-88422
25mm	17	26	0.9	1-88425
28mm	18	28	0.9	1-88428
29mm	19	28	0.9	1-88429
32mm	20	30	0.9	1-88432
35mm	22	31	0.9	1-88435
40mm	24	34	0.9	1-88440
44mm	26	36	0.9	1-88444
48mm	28	38	0.9	1-88448
52mm	30	40	0.9	1-88452
56mm	32	42	0.9	1-88456
60mm	34	44	0.9	1-88460

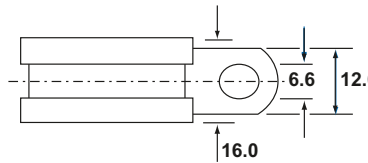
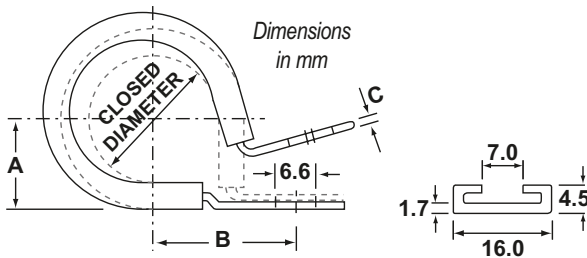

JCS MULTI-TORQUE KITS



MULTI-TORQUE KITS

JCS have coupled the strength of HI-TORQUE hose clamps with the convenience of being able to produce instant hose clamps to any desired diameter from a kit. MULTI-TORQUE kits are manufactured to the same high quality standards as HI-TORQUE clamps.

- Ideal for maintenance applications
- All parts are 100% stainless steel (18/8 marine quality - BS 304)
- Significantly stronger than other adjustable banding products.

By cutting off the required length from banding roll and engaging one end into each housing on the MULTI-TORQUE connector a hose clamp is made and it is reusable.

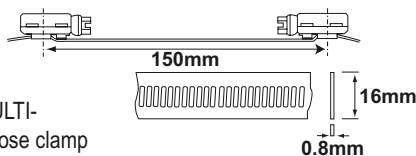

Description	Part No.
Multi-Torque S/S Band Connectors per 10	1-88350
Multi-Torque S/S Banding per 10m	1-88351
Multi-Torque S/S Band Kit 1m	1-88354

JUBILEE JUNIORS NUT & BOLT CLIPS

Jubilee Juniors are for use on fuel pipes and small bore hoses.

Pack Size: 50 per bag*

Specifications:

Tightening Torque:	Maximum 1.2Nm
Screw:	7mm A/F
Material:	Zinc finished mild steel
Band Width:	9mm



Adjustment	Part No.
07 - 09mm	1-87409
08 - 10mm	1-87410
09 - 11mm	1-87411
10 - 12mm	1-87412

*Also available in bags of 10 - add /10 to any of the above part nos (for e.g 1-87409/10)

S/STEEL DOUBLE BOLT CLAMPS

- For applications where higher pressures and great strength is required
- Provides great size range & wider band width with sizes up to 350mm
- Available to special order



JUBILEE WORM DRIVE HOSE CLIPS

Jubilee is the original worm drive hose clip and for more than seventy years the company has supplied both original equipment and resale customers worldwide.

From the original patents to the current BS requirements the company has led the world with consistent high quality; combined with this has been eye catching point of sale material and practical packaging. The comprehensive range of products enables users everywhere to be confident that Jubilee has a clip to suit their application.

Jubilee Worm Drive Clips are Kitemarked to BS 5315:1991.



Jubilee were instrumental in the formulation of the original British Standards and as user customers all over the world will testify, the consistent high level of reliability has set Jubilee apart from its competitors.

The S/S range of Jubilee worm drive hose clips are Lloyds Type approved to BS 5315:1991



Specifications

Material:	Mild Steel (Zinc Plated)
Band:	BS1449 Pt.1
Housing:	BS1449 Pt.1
Screw:	BS3111
Zinc Finish:	Meets BS7479 48 Hrs NSS

Specifications

Material:	304 Stainless Steel
All components:	Type 304, BS1449 Pt. 2, (Band, Housing & Screw)

ZINC PLATED MILD STEEL & STAINLESS STEEL HOSE CLIPS

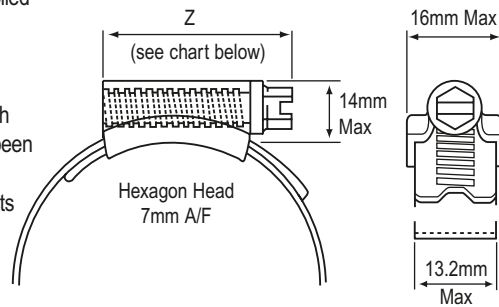

The performance of hose clips is determined by the hose type, spigot, tightening torque and hose working pressures.

* The maximum recommended tightening torque figures are based on the BSS Tightening Torque (75% of break).

BS No.	Size No.	Adjustment		Band Width mm	'Z' Max.	Band Thickness mm	Max. Rec. Tightening Torque Nm	Zinc Plated	S/Steel	Box Qty
		mm	inches							
12	OOO	9.5 - 12	3/8 - 1/2	9	21	0.762	3.38	1-87012	1-87112	10
16	MOO	11 - 16	1/2 - 5/8	9	21	0.762	3.38	1-87016	1-87116	10
20	OO	13 - 20	1/2 - 3/4	9	21	0.762	3.38	1-87020	1-87120	10
22	O	16 - 22	5/8 - 7/8	13	25	0.914	4.20	1-87022	1-87122	10
25	OX	18 - 25	3/4 - 1	13	25	0.914	4.20	1-87025	1-87125	10
30	1A	22 - 30	7/8 - 1 1/8	13	29	0.914	5.10	1-87030	1-87130	10
35	1	25 - 35	1 - 1 1/8	13	29	0.914	5.10	1-87035	1-87135	10
40	1X	30 - 40	1 1/8 - 1 3/8	13	29	0.914	5.10	1-87040	1-87140	10
45	1M	32 - 45	1 1/4 - 1 3/4	13	29	0.914	5.10	1-87045	1-87145	10
50	2A	35 - 50	1 1/4 - 1 7/8	13	33	0.914	5.93	1-87050	1-87150	10
55	2	40 - 55	1 1/2 - 2 1/8	13	33	0.914	5.93	1-87055	1-87155	10
60	2X	45 - 60	1 3/4 - 2 3/8	13	33	0.914	5.93	1-87060	1-87160	10
70	3	50 - 70	2 - 2 3/4	13	33	0.914	6.75	1-87070	1-87170	10
80	3X	60 - 80	2 3/8 - 3 1/8	13	33	0.914	6.75	1-87080	1-87180	each
90	4	70 - 90	2 3/4 - 3 1/2	13	33	0.914	6.75	1-87090	1-87190	each
100	4X	85 - 100	3 3/4 - 4	13	33	0.914	6.75	1-87091	1-87191	each
120	5	90 - 120	3 3/4 - 4 1/2	13	33	0.914	6.75	1-87092	1-87192	each
140	6	110 - 140	4 1/4 - 5 1/2	13	33	0.914	6.75	1-87093	1-87193	each
150	6X	130 - 150	5 - 5 3/4	13	33	0.914	5.93	1-87094	1-87194	each

JUBILEE FLEXIDRIVER® & JUBILEE CLIPDRIVER®

All are high quality precision products incorporating a 7mm A/F socket head especially designed for Jubilee Worm Drive hose clips.

The three types suit most workshops, maintenance and DIY applications.



- 1-87400 Jubilee Flexidriver
- 1-87401 Jubilee Clipdriver 95mm
- 1-87402 Jubilee Clipdriver 160mm

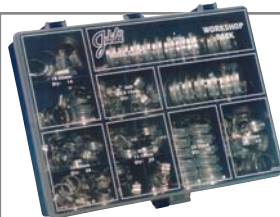

WORKSHOP PACK

Versatile, re-usable box: 8 compartments holding 143 assorted Jubilee worm drive hose clips.

Part No. 1-87006 Zinc Plated
Part No. 1-87106 Stainless Steel

Size	Adjustments	Qty
OOO	9.5 - 12mm	24
MOO	11 - 16mm	32
OO	13 - 20mm	28
O	16 - 22mm	13
OX	18 - 25mm	14
1A	22 - 30mm	12
1	25 - 35mm	13
1X	30 - 40mm	7

HOSE CLIP DISPENSER STAND

The new improved CD 100 offers the ultimate point of sale worm drive hose clip dispenser.

Eye catching and functional, your stock turn will significantly improve.

Dimensions (mm): 340x330wx180d

Part No. 1-87000 Zinc Plated
Part No. 1-87100 Stainless Steel



No. of Clips	Size	BS No.	Adjustment	
			mm	Inches
10	OOO	12	9.5 - 12	3/8 - 1/2
10	MOO	16	11 - 16	1/2 - 5/8
10	OO	20	13 - 20	1/2 - 3/4
10	O	22	16 - 22	5/8 - 7/8
10	OX	25	18 - 25	3/4 - 1
10	1A	30	22 - 30	7/8 - 1 1/8
10	1	35	25 - 35	1 - 1 1/8
10	1X	40	30 - 40	1 1/8 - 1 3/8
10	1M	45	32 - 45	1 1/4 - 1 3/4
10	2A	50	35 - 50	1 1/4 - 1 7/8

JUBILEE HIGH TORQUE STAINLESS STEEL HOSE CLIPS

HIGH TORQUE STAINLESS STEEL

Jubilee High Torque clips for applications that require extra high levels of tightening torque. They can be used on hose applications such as spiral wound wire reinforced suction hose. High Torque clips are appropriate in those heavy duty situations where the general British Standard product is not suitable.

- Twice the tightening torque of standard worm drive hose clips which creates more than twice the band tension for those stubborn leakage and high vibration applications.
- All stainless steel construction.
- Breaking torque of Jubilee High Torque is comparable to conventional 'T' bolt clamps of equal size.
- Recommended tightening torque 17 Nm (150 lb in).



Size	Dia. mm	Dia. ins	Part No.
35	20 - 35	¾ - 1⅜	1-87311
40	25 - 40	1 - 1⅝	1-87312
45	25 - 45	1 - 1¼	1-87313
50	30 - 50	1¼ - 2	1-87314
70	40 - 70	1⅝ - 2¾	1-87318
80	60 - 80	2⅝ - 3⅝	1-87320
95	70 - 95	2¾ - 3¾	1-87323
100	80 - 100	3⅜ - 4	1-87324
120	90 - 120	3½ - 4¾	1-87328
140	110 - 140	4⅜ - 5½	1-87330
160	130 - 160	5⅞ - 6¼	1-87332
180	150 - 180	5⅞ - 7	1-87334
200	170 - 200	6¾ - 7⅞	1-87336
220	190 - 220	7½ - 8⅝	1-87338
240	210 - 240	8¼ - 9½	1-87340
260	230 - 260	9 - 10¼	1-87342
280	250 - 280	9⅞ - 11	1-87344
300	270 - 300	10⅝ - 11¾	1-87346
320	290 - 320	11⅜ - 12½	1-87348
340	310 - 340	12¼ - 13⅜	1-87350

Material Specification:

Band:	BS/AISI 304 A2
Housing:	BS/AISI 304 A2
Screw:	BS/AISI 410

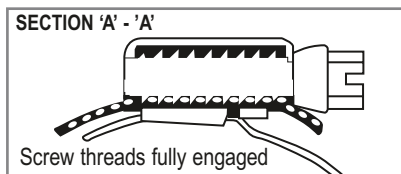
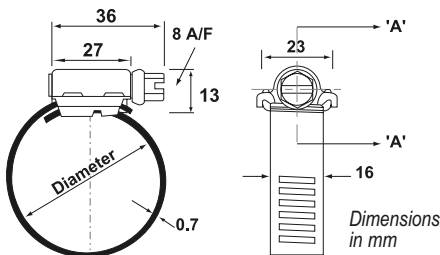

Sold Singly

JUBILEE HEAVY DUTY BOLT CLAMPS



JUBILEE SUPERCLAMPS

Used for demanding situations, the Jubilee Superclamp is easily adjusted by a single nut and bolt.

Available in Zinc plated mild steel (yellow passivated) and 316 (A4) Stainless steel

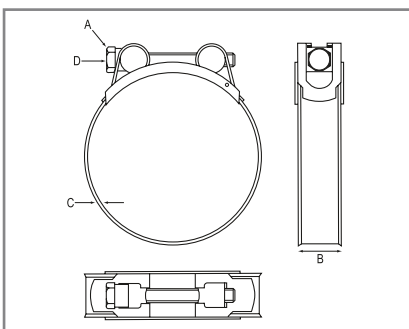

Min-Max Dia. mm	Screw DIN 933 (A)	Band Width mm (B)	Band Thickness mm (C)	Max. Rec. Tightening Torque Nm*	Screw Head A/F mm (D)	Part No. Zinc Plated	Part No. S/Steel
17-19						1-87610	1-87710
20-22						1-87611	1-87711
23-25						1-87612	1-87712
26-28	M5	18	0.6	6	8	1-87613	1-87713
29-31						1-87614	1-87714
32-35						1-87615	1-87715
36-39						1-87616	1-87716
40-43						1-87617	1-87717
44-47						1-87618	1-87718
48-51						1-87619	1-87719
52-55						1-87620	1-87720
56-59						1-87621	1-87721
60-63	M6	20	1.0	8	10	1-87622	1-87722
64-67						1-87623	1-87723
68-73						1-87624	1-87724
74-79						1-87625	1-87725
80-85						1-87626	1-87726
86-91						1-87627	1-87727
92-97						1-87628	1-87728
98-103						1-87629	1-87729
104-112						1-87630	1-87730
113-121						1-87631	1-87731
122-130	M8	25	1.5	25	13	1-87632	1-87732
131-139						1-87633	1-87733
140-148						1-87634	1-87734
149-161						1-87635	1-87735
162-174						1-87636	1-87736
175-187						1-87637	1-87737
188-200						1-87638	1-87738
201-213						1-87639	1-87739
214-226	M8	25	1.8	25	13	1-87640	1-87740
227-239						1-87641	1-87741
240-252						-	1-87742
253-265						-	1-87743

* Maximum recommended tightening torque (Nm) figures are based on Zinc Plated Mild Steel range.

BRITISH MADE COMPRESSION PIPE FITTINGS

We normally stock either WADE® fittings or an alternative British made supplier depending on availability.

WADE® Fittings have been manufactured and distributed for 50 years. So successful has the product been, that Wade Brass has become the generic term for Brass Compression Fittings for engineering purposes. WADE® Brass, which is synonymous with durability and reliability, provides a comprehensive range of fittings for both imperial and metric OD tube sizes. These are available in a full range of connecting threads. Through the adoption of a standard body, a variety of tubes of similar and dissimilar material can be connected.

WADE® Fittings can be found in general use throughout the following industries: hydraulic, pneumatic, automotive, locomotive, LPG, oil and gas, power generation, air conditioning, heating and ventilation.

All our compression fittings are manufactured to BS 2051 Part 2 and from material to all of the following standards:

Bar Parts: BS EN 12164, CW609N

Stampings: BS EN 12164, CW617N

Castings: BS EN 1982, CC491K

Copper Rings: BS EN 12449, CW024A

All compression fittings are complete with nuts and annealed copper rings as standard, for use with copper tube.

METRIC/IMPERIAL IDENTIFICATION

METRIC NUT

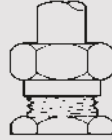

IMPERIAL NUT

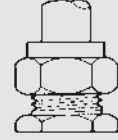

NPT / BSPT IDENTIFICATION

NPT THREAD

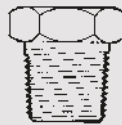

CHAMFERED
FACE

BSPT THREAD

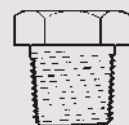

FLAT
FACE

WORKING PRESSURES

The recommended maximum working pressures conform to BS 2051 part 1 for temperatures up to 65°C under vibration free conditions. Please ensure the tube to be used is suitable for the pressures required.

IMPERIAL OD Inches	PRESSURE PSI		METRIC OD mm	PRESSURE BAR	
	Hydraulic	Pneumatic		Hydraulic	Pneumatic
1/8 - 5/16	3,000	1,500	4 - 8	200	105
3/8	2,000	1,000	9 - 10	140	70
1/2 - 5/8	1,500	750	11 - 15	100	50
3/4	1,000	500			



COMPRESSION RINGS
- BRASS Sold per 10

Size	Part No.
1/8"	1-19011
3/16"	1-19013
1/4"	1-19014
5/16"	1-19015
3/8"	1-19016
1/2"	1-19017
5/8"	1-19018
3/4"	1-19019
1"	1-19020

Size	Part No.
4mm	1-26031
5mm	1-26032
6mm	1-26033
8mm	1-26035
10mm	1-26037
12mm	1-26039
15mm	1-26042



COUPLING NUTS
Sold Singly

Tube OD	BSP	Part No.
1/8"	1/8"	1-15095
3/16"	1/8"	1-15097
1/4"	1/4"	1-15098
5/16"	1/4"	1-15099
3/8"	3/8"	1-15100
1/2"	1/2"	1-15101
5/8"	5/8"	1-15102
3/4"	3/4"	1-15103

Tube OD	BSP	Part No.
4mm	1/8"	1-25091
5mm	1/8"	1-25092
6mm	1/4"	1-25093
8mm	1/4"	1-25095
10mm	3/8"	1-25097
12mm	3/8"	1-25099
15mm	1/2"	1-25100



COMPRESSION RINGS
- COPPER Sold per 10

Size	Part No.
1/8"	1-19021
3/16"	1-19023
1/4"	1-19024
5/16"	1-19025
3/8"	1-19026
1/2"	1-19027
5/8"	1-19028
3/4"	1-19029

Size	Part No.
4mm	1-19070
5mm	1-19071
6mm	1-19072
8mm	1-19073
10mm	1-19074
12mm	1-19075
15mm	1-19076



COMPRESSION FERRULES Sold per 10

- To suit medium size flexible nylon tubing

Tube OD	Tube ID	Part No.
3/8"	.117mm	1-19032
1/4"	.170mm	1-19033
5/16"	.212mm	1-19034
3/8"	.250mm	1-19035
1/2"	.375mm	1-19036

Tube OD	Tube ID	Part No.
5mm	3.3mm	1-19042
6mm	4.0mm	1-19043
8mm	5.5mm	1-19044
10mm	7.0mm	1-19045
12mm	8.5mm	1-19046



STRAIGHT COUPLINGS (EQUAL & REDUCING)

Tube OD x Tube OD	Part No.
1/8" x 1/8"	1-12010
3/16" x 1/8"	1-12020
3/16" x 3/16"	1-12060
1/4" x 1/8"	1-12065
1/4" x 3/16"	1-12080
1/4" x 1/4"	1-12090
5/16" x 1/8"	1-12095
5/16" x 3/16"	1-12100
5/16" x 1/4"	1-12110
5/16" x 5/16"	1-12120
3/8" x 3/16"	1-12125
3/8" x 1/4"	1-12130
3/8" x 5/16"	1-12140
3/8" x 3/8"	1-12150
1/2" x 1/4"	1-12160
1/2" x 5/16"	1-12170
1/2" x 3/8"	1-12180
1/2" x 1/2"	1-12190
5/8" x 1/2"	1-12191
5/8" x 5/8"	1-12200
3/4" x 3/4"	1-12210
1" x 1"	1-12220

Tube OD x Tube OD	Part No.
4mm x 4mm	1-21510
5mm x 5mm	1-21520
6mm x 4mm	1-21530
6mm x 6mm	1-21540
8mm x 8mm	1-21570
10mm x 6mm	1-21590
10mm x 10mm	1-21610
12mm x 8mm	1-21640
12mm x 12mm	1-21660
15mm x 15mm	1-21690

For Imperial to Metric Straight Couplings see page 26



BSP LOCK NUTS

BSP	Part No.
1/8"	1-19740
1/4"	1-19741
3/8"	1-19742
1/2"	1-19743
3/4"	1-19744
1"	1-19745



MALE STUD COUPLINGS BSP PARALLEL

Tube OD x BSP Male	Part No.
1/8" x 1/8"	1-13010
3/16" x 1/8"	1-13020
3/16" x 1/4"	1-13060
3/16" x 3/8"	1-13065
1/4" x 1/8"	1-13070
1/4" x 1/4"	1-13080
1/4" x 3/8"	1-13090
1/4" x 1/2"	1-13100
5/16" x 1/8"	1-13110
5/16" x 1/4"	1-13120
5/16" x 3/8"	1-13130
5/16" x 1/2"	1-13140
3/8" x 1/4"	1-13150
3/8" x 3/8"	1-13160
3/8" x 1/2"	1-13170
1/2" x 1/4"	1-13180
1/2" x 3/8"	1-13190
1/2" x 1/2"	1-13200
5/8" x 1/2"	1-13210
3/4" x 3/4"	1-13220
1" x 1"	1-13230

Tube OD x BSP Male	Part No.
4mm x 1/8"	1-23710
5mm x 1/8"	1-23714
5mm x 1/4"	1-23716
6mm x 1/8"	1-23720
6mm x 1/4"	1-23730
6mm x 3/8"	1-23740
8mm x 1/8"	1-23750
8mm x 1/4"	1-23760
8mm x 3/8"	1-23770
8mm x 1/2"	1-23780
10mm x 1/4"	1-23790
10mm x 3/8"	1-23800
10mm x 1/2"	1-23810
12mm x 1/4"	1-23820
12mm x 3/8"	1-23830
12mm x 1/2"	1-23840
15mm x 1/2"	1-23860



BLANK NUTS

BSP	Part No.
1/8"	1-19710
1/4"	1-19711
3/8"	1-19712
1/2"	1-19713



MALE STUD COUPLINGS BSP TAPER

Tube OD x BSP Taper	Part No.
1/8" x 1/8"	1-14010
1/8" x 1/4"	1-14015
3/16" x 1/8"	1-14030
3/16" x 1/4"	1-14040
1/4" x 1/8"	1-14050
1/4" x 1/4"	1-14060
1/4" x 3/8"	1-14070
1/4" x 1/2"	1-14080
5/16" x 1/8"	1-14090
5/16" x 1/8"	*1-14095
5/16" x 1/4"	1-14100
5/16" x 1/4"	*1-14105
5/16" x 3/8"	1-14110
5/16" x 1/2"	1-14115
3/8" x 1/8"	1-14117
3/8" x 1/4"	1-14120
3/8" x 3/8"	1-14130
3/8" x 1/2"	1-14140
1/2" x 1/4"	1-14150
1/2" x 3/8"	1-14160
1/2" x 1/2"	1-14170
5/8" x 1/2"	1-14180
3/4" x 3/4"	1-14190
1" x 1"	1-14200

Tube OD x BSP Taper	Part No.
4mm x 1/8"	1-25210
4mm x 1/4"	1-25212
5mm x 1/4"	1-25216
6mm x 1/8"	1-25220
6mm x 1/4"	1-25230
6mm x 3/8"	1-25240
8mm x 1/8"	1-25250
8mm x 1/4"	1-25260
8mm x 3/8"	1-25270
10mm x 1/4"	1-25280
10mm x 3/8"	1-25290
10mm x 1/2"	1-25300
12mm x 1/4"	1-25310
12mm x 3/8"	1-25320
12mm x 1/2"	1-25330
15mm x 3/8"	1-25345
15mm x 1/2"	1-25360

SCREWED PLUG TAPER THREAD



BSP	Part No.
1/8"	1-19720
1/4"	1-19721
3/8"	1-19722
1/2"	1-19723



FEMALE STUD COUPLINGS BSP PARALLEL

Tube OD x BSP Female	Part No.
1/8" x 1/8"	1-17000
1/8" x 1/4"	1-17005
3/16" x 1/8"	1-17010
3/16" x 1/4"	1-17020
3/16" x 3/8"	1-17025
1/4" x 1/8"	1-17030
1/4" x 1/4"	1-17040
1/4" x 3/8"	1-17041
1/4" x 1/2"	1-17043
5/16" x 1/8"	1-17042
5/16" x 1/4"	1-17050
5/16" x 3/8"	1-17051
5/16" x 1/2"	1-17052
3/8" x 1/4"	1-17060
3/8" x 3/8"	1-17070
3/8" x 1/2"	1-17080
1/2" x 3/8"	1-17090
1/2" x 1/2"	1-17100
3/4" x 3/4"	1-17110
1" x 1"	1-17120

Tube OD x BSP Female	Part No.
4mm x 1/8"	1-22410
4mm x 1/4"	1-22420
5mm x 1/8"	1-22414
5mm x 1/4"	1-22416
6mm x 1/8"	1-22430
6mm x 1/4"	1-22440
8mm x 1/8"	1-22460
8mm x 1/4"	1-22470
8mm x 3/8"	1-22480
10mm x 1/4"	1-22500
10mm x 3/8"	1-22510
10mm x 1/2"	1-22520
12mm x 1/4"	1-22525
12mm x 3/8"	1-22530
12mm x 1/2"	1-22540
15mm x 3/8"	1-22550
15mm x 1/2"	1-22560

FLANGED MALE PLUGS PARALLEL



BSP	Part No.
1/8"	1-19730
1/4"	1-19731
3/8"	1-19732
1/2"	1-19733
3/4"	1-19734
1"	1-19735

* FITTED WITH 5/16" OD FERRULE
FOR NYLON TUBE



EQUAL ELBOW COUPLINGS

Tube OD x Tube OD	Part No.
1/8" x 1/8"	1-18010
3/16" x 3/16"	1-18030
1/4" x 1/4"	1-18050
5/16" x 1/4"	1-18060
5/16" x 5/16"	1-18070
3/8" x 3/8"	1-18100
1/2" x 1/2"	1-18110
5/8" x 5/8"	1-18111
3/4" x 3/4"	1-18120
1" x 1"	1-18130

Tube OD x Tube OD	Part No.
4mm x 4mm	1-28610
5mm x 5mm	1-28620
6mm x 6mm	1-28630
8mm x 8mm	1-28650
10mm x 10mm	1-28670
12mm x 12mm	1-28690
15mm x 15mm	1-28720



MALE STUD ELBOW BSP PARALLEL

Tube OD x BSP Male	Part No.
3/16" x 1/8"	1-18250
1/4" x 1/8"	1-18255
1/4" x 1/4"	1-18260
5/16" x 1/8"	1-18265
5/16" x 1/4"	1-18270
3/8" x 1/4"	1-18280
3/8" x 3/8"	1-18290
1/2" x 1/2"	1-18300

Tube OD x BSP Male	Part No.
6mm x 1/4"	1-27410
8mm x 1/4"	1-27420
10mm x 1/4"	1-27430
10mm x 3/8"	1-27440
12mm x 1/4"	1-27450
12mm x 3/8"	1-27460
12mm x 1/2"	1-27470



MALE STUD ELBOW BSP TAPER

Tube OD x BSP Male	Part No.
1/8" x 1/8"	1-18500
3/16" x 1/8"	1-18510
3/16" x 1/4"	1-18515
1/4" x 1/8"	1-18520
1/4" x 1/4"	1-18530
1/4" x 3/8"	1-18535
5/16" x 1/8"	1-18540
5/16" x 1/4"	1-18550
5/16" x 3/8"	1-18555
5/16" x 1/2"	1-18556
3/8" x 1/4"	1-18560
3/8" x 3/8"	1-18570
3/8" x 1/2"	1-18580
1/2" x 1/4"	1-18581
1/2" x 3/8"	1-18590
1/2" x 1/2"	1-18600
5/8" x 1/2"	1-18605
3/4" x 3/4"	1-18610



FEMALE STUD ELBOW BSP PARALLEL

Tube OD x BSP Female	Part No.
3/16" x 1/8"	1-18350
1/4" x 1/8"	1-18355
1/4" x 1/4"	1-18360
1/4" x 3/8"	1-18365
5/16" x 1/4"	1-18370
5/16" x 3/8"	1-18375
3/8" x 1/4"	1-18380
3/8" x 3/8"	1-18390
3/8" x 1/2"	1-18395
1/2" x 3/8"	1-18399
1/2" x 1/2"	1-18400

Tube OD x BSP Female	Part No.
6mm x 1/4"	1-27810
8mm x 1/8"	1-27815
8mm x 1/4"	1-27820
10mm x 1/4"	1-27830
10mm x 3/8"	1-27840
12mm x 3/8"	1-27860
15mm x 1/2"	1-27870



SINGLE BANJO COUPLING

- With steel bolt
- Supplied with copper washers as standard

Tube	Bolt	Part No.
1/4"	1/8"	1-14310
1/4"	1/4"	1-14315
5/16"	1/8"	1-14320
5/16"	1/4"	1-14325
3/8"	1/4"	1-14330
3/8"	3/8"	1-14335
1/2"	3/8"	1-14340
1/2"	1/2"	1-14345

Tube	Bolt	Part No.
6mm	1/4"	1-14415
8mm	1/8"	1-14420
8mm	1/4"	1-14425
10mm	3/8"	1-14435
12mm	3/8"	1-14440
12mm	1/2"	1-14445



FEMALE TO FEMALE ADAPTORS - BSP PARALLEL

BSP	BSP	Part No.
1/8"	1/8"	1-25400
1/4"	1/8"	1-25401
1/4"	1/4"	1-25402
3/8"	1/8"	1-25403
3/8"	1/4"	1-25404
3/8"	3/8"	1-25405
1/2"	1/4"	1-25406
1/2"	3/8"	1-25407
1/2"	1/2"	1-25408

FEMALE PRESSURE GAUGE CONNECTORS BSP PARALLEL



Tube	BSP	Part No.
1/4"	1/4"	1-17244
1/4"	3/8"	1-17245
1/4"	1/2"	1-17246
3/8"	3/8"	1-17247
3/8"	1/2"	1-17248



FEMALE STUD COUPLING - BSPT

Tube	BSPT	Part No.
1/4"	1/8"	1-17130
1/4"	1/4"	1-17140
1/4"	3/8"	1-17141
5/16"	1/8"	1-17145
5/16"	1/4"	1-17150
5/16"	3/8"	1-17151
3/8"	1/4"	1-17160
3/8"	3/8"	1-17170
3/8"	1/2"	1-17180



**TEE COUPLINGS
EQUAL**

Tube OD	Part No.
1/8" x 1/8" x 1/8"	1-18810
3/16" x 3/16" x 3/16"	1-18830
1/4" x 1/4" x 1/4"	1-18860
5/16" x 5/16" x 5/16"	1-18930
3/8" x 3/8" x 3/8"	1-18980
1/2" x 1/2" x 1/2"	1-18990
5/8" x 5/8" x 5/8"	1-18991
3/4" x 3/4" x 3/4"	1-19000
1" x 1" x 1"	1-19005

Tube OD (mm)	Part No.
4 x 4 x 4	1-29610
5 x 5 x 5	1-29620
6 x 6 x 6	1-29630
8 x 8 x 8	1-29660
10 x 10 x 10	1-29690
12 x 12 x 12	1-29720
15 x 15 x 15	1-29750



**UNEQUAL BRANCH
TEES**

Tube	Tube	Tube	Part No.
1/4"	5/16"	3/8"	1-19103
1/4"	3/8"	1/2"	1-19104
5/16"	1/4"	1/4"	1-19106
5/16"	3/8"	3/8"	1-19107
3/8"	1/4"	1/4"	1-19108
3/8"	5/16"	5/16"	1-19109

**135° MALE
STUD ELBOW -
BSP TAPER**



Tube OD	Stud Size	Part No.
1/4"	1/4"	1-18710



**UNEQUAL BRANCH
TEES**

Tube	Tube	Branch	Part No.
1/4"	1/4"	3/16"	1-18840
5/16"	5/16"	3/16"	1-18910
5/16"	5/16"	1/4"	1-18920
5/16"	5/16"	3/8"	1-18940
3/8"	3/8"	1/4"	1-18970
3/8"	3/8"	5/16"	1-18971
3/8"	3/8"	1/2"	1-18972
1/2"	1/2"	1/4"	1-18983
1/2"	1/2"	3/8"	1-18985
1"	1"	3/4"	1-19006



EQUAL ENDED CROSS

Tube OD	Part No.
1/4"	1-17573
5/16"	1-17574
3/8"	1-17575



EQUAL ENDED 'Y' PIECE

Tube OD	Part No.
1/4"	1-18635
5/16"	1-18640



**FEMALE BRANCH TEE
BSP PARALLEL**

Tube OD	Tube OD	Stud Stud	Part No.
1/4"	1/4"	1/8"	1-18750
1/4"	1/4"	1/4"	1-18755
5/16"	5/16"	1/8"	1-18760
5/16"	5/16"	1/4"	1-18765
3/8"	3/8"	1/4"	1-18770



BULKHEAD COUPLINGS

Tube OD	Max. B/Head Thickness	Part No.
1/8"	1/4"	1-17500
3/16"	3/8"	1-17510
1/4"	3/16"	1-17515
1/4"	3/8"	1-17520
1/4"	5/8"	1-17525
5/16"	3/16"	1-17527
5/16"	3/8"	1-17530
5/16"	5/8"	1-17535
3/8"	3/8"	1-17540
3/8"	3/4"	1-17545
1/2"	1/2"	1-17550
1/2"	3/4"	1-17555
3/4"	1/2"	1-17560
1"	1/2"	1-17570

Tube OD	Max. B/Head Thickness	Part No.
4mm	3/8"	1-24610
5mm	3/8"	1-24615
6mm	3/8"	1-24620
8mm	3/8"	1-24630
10mm	3/8"	1-24640
12mm	3/8"	1-24650
15mm	3/8"	1-24660
16mm	3/8"	1-24661



**MALE BRANCH TEE -
BSP TAPER**

Tube OD	Tube OD	T. Stud	Part No.
1/4"	1/4"	1/8"	1-29815
1/4"	1/4"	1/4"	1-29820
5/16"	5/16"	1/8"	1-29830
5/16"	5/16"	1/4"	1-29835
3/8"	3/8"	1/4"	1-29845
3/8"	3/8"	3/8"	1-29850
1/2"	1/2"	1/2"	1-29860

Tube OD	Tube OD	T. Stud	Part No.
6mm	6mm	1/8"	1-29910
10mm	10mm	1/4"	1-29930



**MALE RUN TEE - BSP
TAPER**

Tube OD	Tube OD	Stud	Part No.
1/4"	1/4"	1/8"	1-29503
1/4"	1/4"	1/4"	1-29504
5/16"	5/16"	1/8"	1-29505
5/16"	5/16"	1/4"	1-29506
3/8"	3/8"	1/4"	1-29507
3/8"	3/8"	3/8"	1-29508

Tube OD	Tube OD	Stud	Part No.
10mm	10mm	3/8"	1-29524

SPECIALS:

- 1-14210 MALE STUD COUPLING M14 x1.5 1/4" TUBE
- 1-14211 MALE STUD COUPLING M14 x1.5 5/16" TUBE
- 1-14212 MALE STUD COUPLING M14 x1.5 3/8" TUBE
- 1-14508 COUPLING STAND PIPE ELBOW 3/8"
- 1-16281 STEM NOZZLE ADAPTOR 5/16" HOSE
- 1-16282 STEM NOZZLE ADAPTOR 3/8" HOSE

We also stock NPT Threaded versions of the fittings below:

- MALE STUD COUPLINGS
- FEMALE STUD COUPLINGS
- MALE STUD ELBOWS
- SCREWED PLUGS



FOOT MOUNTED VALVE

- Fitted with compression ends
- Maximum working pressure 100psi/6.7bar



NEEDLE VALVE

- Foot mounted for tube.

Tube OD	Tube OD	Part No.
1/4"	1/4"	1-20022



NEEDLE VALVE

- Foot mounted for hose.

Tube OD	Hose OD	Part No.
1/4"	3/8"	1-20025



STRAIGHT NEEDLE VALVE PANEL MOUNTING - TUBE x TUBE

Tube OD	Spindle Type	Part No.
1/4"	Brass	1-20251
1/4"	Al/Bronze	1-20253



IMPERIAL TO METRIC STRAIGHT COUPLING

Tube OD	Tube OD	Part No.
1/4"	6mm	1-12240
3/8"	10mm	1-12250
1/2"	12mm	1-12260
3/8"	15mm	1-12270

BRASS PLUG COCK

- Ideal for applications requiring a quick and positive shut-off where easily visible open & shut positions are needed
- Maximum working pressure 30psi/2bar



TUBE X BSP MALE PARALLEL STUD

- Foot mounted for tube.

Tube OD	BSP	Part No.
3/16"	1/8"	1-20011
1/4"	1/4"	1-20012
5/16"	1/4"	1-20013
3/8"	3/8"	1-20014
1/2"	1/2"	1-20016



TUBE X TUBE

Tube OD	Tube OD	Part No.
3/16"	3/16"	1-20001
1/4"	1/4"	1-20002
5/16"	5/16"	1-20003
3/8"	3/8"	1-20004
1/2"	1/2"	1-20005

Tube OD	Tube OD	Part No.
6mm	6mm	1-20042
8mm	8mm	1-20043
10mm	10mm	1-20044



BULKHEAD NOZZLE

- For rubber hose.
- Bulkhead thickness 1/4"

Tube OD	Hose	Part No.
1/4"	3/8"	1-16215
5/16"	3/8"	1-16216
3/8"	3/8"	1-16217



TEST POINT UNION

Tube OD	Part No.
1/4"	1-29960
5/16"	1-29961
3/8"	1-29962
1/2"	1-29963
6mm	1-29970
8mm	1-29971
10mm	1-29972
12mm	1-29973



TEST POINT ELBOW

Tube OD	Part No.
1/4"	1-29965
5/16"	1-29966
3/8"	1-29967
1/2"	1-29968
6mm	1-29975
8mm	1-29976
10mm	1-29977
12mm	1-29978



TEST POINT NIPPLE

Tube OD	Part No.
1/8" BSPM	1-29980



STOP END

Tube OD	Part No.
3/16"	1-19051
1/4"	1-19052
5/16"	1-19053
3/8"	1-19054
1/2"	1-19055
6mm	1-25061
8mm	1-25062
10mm	1-25063
12mm	1-25064
15mm	1-25065



HOSE CONNECTORS (FULHAM TYPE) MALE

BSP(M)	Hose ID	Part No.
1/8"	3/8" or 10mm	1-16271
1/4"	3/8" or 10mm	1-16272
3/8"	3/8" or 10mm	1-16273



FEMALE

BSP(F)	Hose ID	Part No.
1/8"	3/8" or 10mm	1-16291
1/4"	3/8" or 10mm	1-16292
3/8"	3/8" or 10mm	1-16293



HOSE CONNECTORS TAPER

BSP(T)	Hose ID	Part No.
1/8"	3/8" or 10mm	1-16261
1/4"	3/8" or 10mm	1-16262
3/8"	3/8" or 10mm	1-16263



HOSE CONNECTORS COMPRESSION

Tube OD	Hose ID	Part No.
3/16"	3/8" or 10mm	1-16275
1/4"	3/8" or 10mm	1-16276
5/16"	3/8" or 10mm	1-16277
3/8"	3/8" or 10mm	1-16278

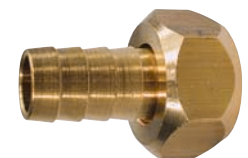

HOSE NOZZLE ADAPTOR

- With swivel nut for hose
- Parallel thread

BSP	Hose	Part No.
1/4"	1/4"	1-16203
1/4"	5/16"	1-16205
3/8"	3/8"	1-16209
1/2"	1/2"	1-16212

PRESTEX COMPRESSION FITTINGS (TYPE A)

Manufactured to EN 1254 (formerly BS864/2), Prestex 'Type A' compression fittings are suitable for mechanically joining copper or stainless steel tube by means of compressing a cone onto the tube without the application of heat. The range is designed for use with copper tube to BS EN 1057: 1996 (formerly BS2871: Part 1), BS2871: Part 2, or stainless steel tube to BS4127: 1994. **We normally stock the Bronze or DZR Brass Range.**

Where a Part No. is followed by the letter 'B' this indicates the material is Brass i.e. 1-52415B. Ask for details on the complete brass range available.



STRAIGHT COUPLING

- Copper x copper

15mm x 15mm	1-54015
22mm x 22mm	1-54022
28mm x 28mm	1-54028
35mm x 35mm	1-54035
42mm x 42mm	1-54042
54mm x 54mm	1-54054



FLANGED TANK CONNECTOR

- Copper x flange & backnut

15mm	1-53515
22mm	1-53522
28mm	1-53528
35mm	1-53535
42mm	1-53542
54mm	1-53554

Medium

	Service Temp up to °C	Maximum Working Pressure	
		BAR	PSI
Water or light mineral oils 8 to 54mm sizes	30	16	230
	65	10	145
	110	6	87
	120	5	75
Compressed air Non-shock 8 to 28mm sizes only	30	7	100
Saturated Steam	120	3	45
LPG & natural gas 8 to 28mm sizes only	30	1	15



STRAIGHT COUPLING

- Copper x female iron

15mm x 1/2" BSP	1-54115
22mm x 3/4" BSP	1-54122
22mm x 1" BSP	1-54123
28mm x 1" BSP	1-54128
35mm x 1 1/4" BSP	1-54135
42mm x 1 1/2" BSP	1-54142
54mm x 2" BSP	1-54154



BIBTAP WALL FLANGE

- Copper x female iron

15mm x 1/2"	1-55815
-------------	---------



EQUAL TEE COUPLING

- All ends equal

15mm	1-55015
22mm	1-55022
28mm	1-55028
35mm	1-55035
42mm	1-55042
54mm	1-55054



BENT COUPLING

- Copper x copper

15mm	1-54415
22mm	1-54422
28mm	1-54428
35mm	1-54435
42mm	1-54442
54mm	1-54454



STRAIGHT COUPLING

- Copper x male iron

15mm x 1/2" BSP	1-54215
22mm x 3/4" BSP	1-54222
22mm x 1" BSP	1-54223
28mm x 1" BSP	1-54228
35mm x 1 1/4" BSP	1-54235
42mm x 1 1/2" BSP	1-54242
54mm x 2" BSP	1-54254



TEE WITH BRACKET

- Copper x female branch

15mm x 1/2" BSP	1-55400
-----------------	---------



TEE BRANCH REDUCED

- All ends for copper

22 (2) x 15mm	1-55522
28 (2) x 15mm	1-55528
28 (2) x 22mm	1-55529
35 (2) x 15mm	1-55535
35 (2) x 28mm	1-55537
42 (2) x 28mm	1-55544



BENT COUPLING

- Copper x male iron

15mm x 1/2" BSP	1-54515
15mm x 3/4" BSP	1-54516
22mm x 3/4" BSP	1-54522
28mm x 1" BSP	1-54528
35mm x 1 1/4" BSP	1-54535
42mm x 1 1/2" BSP	1-54542
54mm x 2" BSP	1-54554



STRAIGHT SWIVEL TAP ADAPTER

- Copper x union nut

15mm x 1/2" BSP	1-54315
15mm x 3/4" BSP	1-54316



STRAIGHT COUPLING

- 1/2" screw with backnut

15mm x 1/2" BSP	1-52415B
22mm x 3/4" BSP	1-52422B
28mm x 1" BSP	1-52428B



TEE

- Copper x female iron branch

15mm (2) x 1/2" BSP	1-55415B
22mm (2) x 3/4" BSP	1-55422B
28mm (2) x 1" BSP	1-55428B



BENT COUPLING

- Copper x female iron

15mm x 1/2" BSP	1-54615
22mm x 3/4" BSP	1-54622
28mm x 1" BSP	1-54628
35mm x 1 1/4" BSP	1-54635
42mm x 1 1/2" BSP	1-54642
54mm x 2" BSP	1-54654



BENT SWIVEL TAP ADAPTER

- Copper x union nut

15mm x 1/2" BSP	1-53415B
22mm x 3/4" BSP	1-53422B



SLOW BEND COUPLING

- Copper x copper

15mm	1-54416
22mm	1-54423



TEE COUPLING

- Both ends reduced

15 (2) x 22mm	1-55016
22 (2) x 28mm	1-55023



BENT COUPLING

- Copper x female iron
- 38mm (1 1/2") screw with backnut

15mm x 1/2"	1-54715B
22mm x 3/4"	1-54722B
28mm x 1"	1-54728

NOTE: Jointing compounds or sealants are not necessary with Prestex fittings; the use of these materials could impair the efficiency of the joint and may contravene local water regulations.

LPG GAS

WARNING: Any work in gas installation should only be carried out by suitably qualified and competent persons. Attention is drawn to the Gas Safety (Installation and Use) Regulations 1994 (as amended) which require the installation of appropriate appliances, regular maintenance and testing of appliances. BS 5482 part 3 1998 refers to installation of LPG appliance in boats, yachts and other vessels.

Aquafax undertakes to supply gas appliances or fittings on the assumption that the installer is qualified and competent.

TYPICAL LPG INSTALLATION FOR A YACHT (PROPANE OR BUTANE)

ALL PRODUCTS SHOULD BE INSTALLED BY QUALIFIED AND COMPETENT PERSONS IN ACCORDANCE WITH THE MANUFACTURERS INSTRUCTIONS

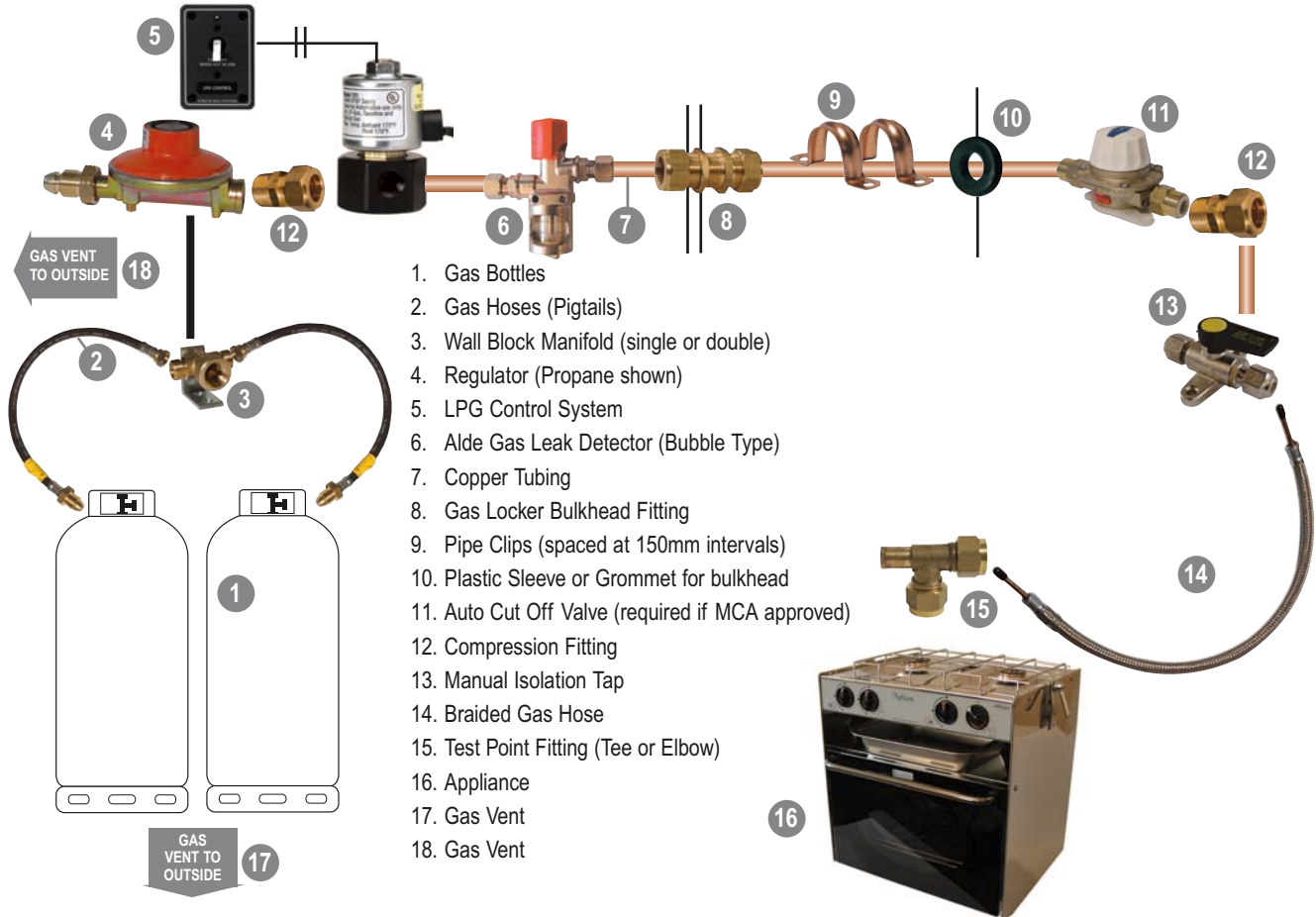

1. Gas Bottles
2. Gas Hoses (Pigtails)
3. Wall Block Manifold (single or double)
4. Regulator (Propane shown)
5. LPG Control System
6. Alde Gas Leak Detector (Bubble Type)
7. Copper Tubing
8. Gas Locker Bulkhead Fitting
9. Pipe Clips (spaced at 150mm intervals)
10. Plastic Sleeve or Grommet for bulkhead
11. Auto Cut Off Valve (required if MCA approved)
12. Compression Fitting
13. Manual Isolation Tap
14. Braided Gas Hose
15. Test Point Fitting (Tee or Elbow)
16. Appliance
17. Gas Vent
18. Gas Vent

LPG CONTROL SYSTEM

- The smallest LPG control panel available. LPG: Propane and Butane
- Amber "ON" indicating LED
- UL Listed solenoid – operates on either high or low pressure side of regulator



8-28071
Panel LPG Control with Solenoid
Solenoid Only 1/4" NPT Inlet Thread



8-28075
Solenoid Only 1/4" NPT Inlet Thread

Specifications	
Panel Material:	0.125" Aluminum 5052 Alloy
Coating:	Chemical Treatment - front and back Two-Part Polyurethane Slate Grey - front
Solenoid Amperage Draw:	0.750 Amps
LED Amperage Draw:	5 Milliamps
Voltage:	12 Volts DC
Dimensions:	2.625" / 66.675mm x 3.75" / 95.25mm

NPT Compression Fittings		
1/4" NPT x 1/4"	Copper Male Stud Coupling	11-14060N
1/4" NPT x 5/16"	Copper Male Stud Coupling	11-14100N
1/4" NPT x 3/8"	Copper Male Stud Coupling	11-14120N

NPT Brass Connectors		
1/4" NPT x 1/4"	Brass Hose Connector	11-75990N
1/4" NPT x 5/16"	Brass Hose Connector	11-75991N
1/4" NPT x 3/8"	Brass Hose Connector	11-75993N
1/4" NPT x 1/2"	Brass Hose Connector	11-75994N

PROPANE SYSTEMS

SMALL SINGLE BOTTLE



REGULATOR 1-59081

SINGLE BOTTLE SYSTEM



WALL BLOCK 1-59211

+



REGULATOR 1-59086

+



1 x 1-59221 20"
or
1 x 1-59223 30"
W20 PIGTAILS

DOUBLE BOTTLE SYSTEM



WALL BLOCK 1-59210

+



REGULATOR 1-59086

+



1 x 1-59221 20"
or
1 x 1-59223 30"
W20 PIGTAILS

DOUBLE BOTTLE MANUAL CHANGEOVER



MANUAL
CHANGEOVER
KIT 1-59015

OPTIONAL



4 CYLINDER UPGRADE KIT
4 Bottle Installation 1-59022

DOUBLE BOTTLE AUTO CHANGEOVER

AUTO CHANGEOVER KIT
1-59020 (with OPSO)
1-59021 (without OPSO)
1-59016 (Budget)



BUTANE SYSTEMS

SMALL SINGLE BOTTLE



REGULATOR 1-59080

LARGE SINGLE BOTTLE



REGULATOR 1-59085

CLIP ON



REGULATOR 1-59088

DOUBLE BOTTLE MANUAL CHANGEOVER



MANUAL
CHANGEOVER
KIT 1-59018

CAMPING GAZ



REGULATOR 1-59090

OR USE



ADAPTOR 1-59095

+



REGULATOR 1-59080



GAS REGULATORS (ALL TO BS 3016)

Part No.	Gas	CONNECTIONS		INLET PRESSURE		OPERATING		CAPACITY		Btu/hr
		Inlet	Outlet	max (bar)	min	mbar	in/wg	kg/hr	ft3/hr	
1-59002	Propane 50P	Pol 105	LP Nozzle (8mm)	20	-	50	20	1	19	47,000
1-59009	Propane 2nd Stage	½" BSP	½" BSP	4	-	37	14.8	10.5	200	500,00
1-59080	Butane 28B	Union 109 Butane Nut	LP Nozzle (8mm)	6	0.2	28	11	1	16	51,200
1-59081	Propane 37P	Pol 105	LP Nozzle (8mm)	20	1.0	37	14	1	21	52,500
1-59085	Butane 28B	Union 109 Butane Nut	¾" BSPF	6	0.5	28	11	3.2	58	185,600
1-59086	Propane 37P	Pol 105	½" BSPF	11	0.5	37	14	6	114	285,000
1-59088	Butane 28B	21mm	LP Nozzle (8mm)	6	0.2	28	11	1	19	61,000
1-59090	Camping Gas	M.16 x 1.5	LP Nozzle (8mm)	6	0.5	29	11	0.8	16	51,200
1-59082	Propane 37P	POL 105	3/8" BSPF	11	0.5	37	14	4	75	187,500

AUTOMATIC CUT OFF VALVE

- For use with either Propane or Butane
- Quick acting quarter turn shut off
- Must be placed in the gas line between the regulator and the appliance
- Detects both loss of pressure or excess flow
- Cuts off gas supply to the appliance automatically and can only be reset manually
- A cut off valve of this type is mandatory on all British fishing vessels over 10 metres in length using LPG (Department of Trade Statutory Instrument 1975 No. 330)



Part No.	Gas	CONNECTIONS		INLET PRESSURE		OPERATING		CAPACITY		Btu/hr
		Inlet	Outlet	max (bar)	min	mbar	in/wg	kg/hr	ft3/hr	
1-59025	Propane or Butane	¾" BSPF	¾" BSPF	0.35	-	20-50	8-20	2.3	44	110,000

CHANGEOVER KITS

Automatic Changeover Regulators ensure continuous gas supply to the customer. When the pressure in the supply cylinder falls, the changeover regulator switches automatically to the reserve cylinder. The indicator arrow turns red when the system has changed over and points to the empty cylinder. The indicator turns white when turned towards the new service cylinder. OPSO = Over pressure shut off - i.e. in excess of 75mbar.

PROPANE AUTOMATIC CHANGEOVER KIT WITH OPSO*

Kit comprises of:

- One automatic changeover regulator
- Two 50cm (20") W20 pigtails with high pressure black hose to BS 3212: Type 2
- POL connectors incorporating excess flow & non-return valves
- One ½" F x F shut off valve



WITH OPSO

Capacity:	4.2kg (200,000 Btu/per hour)	Inlet: POL
Max. Inlet Pressure:	20 bar (294 p.s.i)	Outlet: ½" BSP Female
Outlet Pressure:	37 mbar (14.8"wg)	Part No. 1-59020

Available without OPSO to special order: 1-59021

4 Cylinder Upgrade Kit: Part No. 1-59022 (See page 32)

PROPANE AUTOMATIC CHANGE OVER KIT

Kit comprises of:

- One 924S regulator
- One automatic change over valve
- One Isolation valve
- Two 50cm (20") W20 pigtails with high pressure black hose to BS3212: Type 2
- POL connectors incorporating excess flow & non return valves

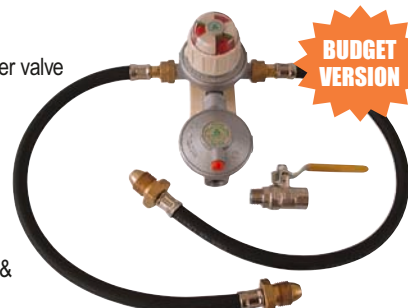

BUDGET VERSION

Capacity:	6kg per hour	Inlet: POL
Max Inlet Pressure:	20bar	Outlet: ¾" BSP Female
Operating Pressure:	37mbar	Part No.1-59016

4 Cylinder Upgrade Kit: Part No. 1-59022 (See page 32)

PROPANE MANUAL CHANGEOVER KIT

Kit comprises of:

- One regulator
- One manual changeover valve
- One thread adaptor
- Two 50cm (20") W20 pigtails with high pressure black hose to BS 3212 : Type 2
- POL connectors incorporating excess flow and non-return valves



Capacity:	4kg (189 000 Btu/per hour)	Inlet: POL
Max. Inlet Pressure:	11 bar (160 p.s.i)	Outlet: ¾" BSP Female
Outlet Pressure:	37 mbar (14.8"wg)	Part No. 1-59015

4 Cylinder Upgrade Kit: Part No. 1-59022 (See page 32)

BUTANE MANUAL CHANGE OVER KIT

Kit comprises of:

- One 734 regulator
- One manual changeover valve
- One threaded adaptor
- Two 50cm (20") W20 pigtails with high pressure black hose to BS3212: Type 2
- Butane connectors incorporating excess flow & non return valves



Capacity:	3.2kg per hour	Inlet: Union 109
Max Inlet Pressure:	6bar	Outlet: ¾" BSP Female
Operating Pressure:	28mbar	Part No.1-59018

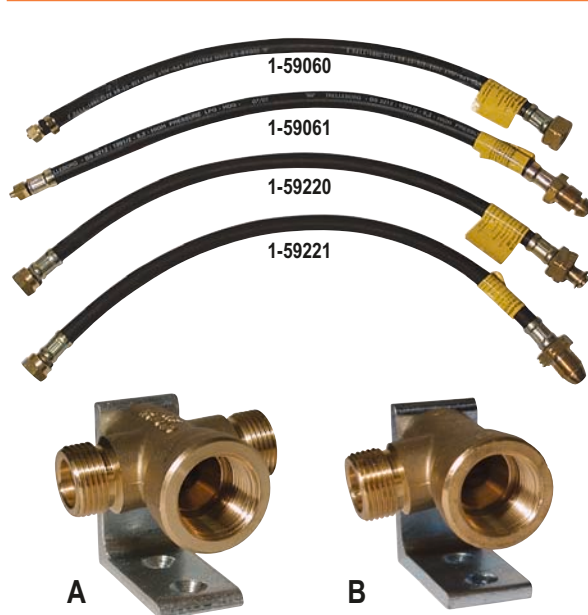

PIGTAIL GAS HOSES TO BS 3212 (TYPE 2)

- For use between gas bottle & regulator but not to exceed 17.5 Bar
- Supplied complete with excess flow valves (EFV) & non-return valves (NRV)

End 1	End 2	Length	Part No.
N2 ¼" BSP Female compression	Butane Nut	50cm (20")	1-59060
N2 ¼" BSP Female compression	Propane POL	50cm (20")	1-59061
N2 ¼" BSP Female compression	Butane Nut	75cm (30")	1-59062
N2 ¼" BSP Female compression	Propane POL	75cm (30")	1-59063
W20	Butane Nut	50cm (20")	1-59220
W20	Propane POL	50cm (20")	1-59221
W20	Butane Nut	75cm (30")	1-59222
W20	Propane POL	75cm (30")	1-59223

PROPANE WALL BLOCKS

- Brass body on steel mounting bracket.
- Double units have non-return valve.

Part No.	Photo	Description	Inlet	Outlet
1-59210	A	Double Wall Block Propane	W20	POL Connection
1-59211	B	Single Wall Block Propane	W20	POL Connection

MINI GAS BALL VALVES

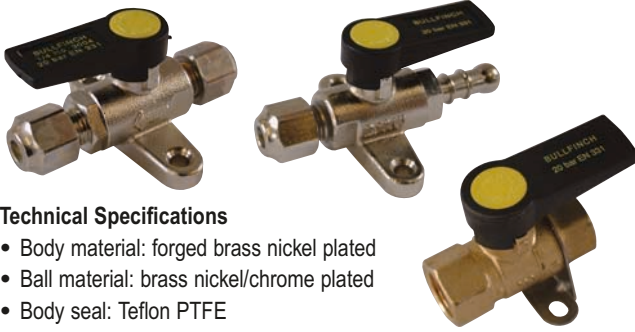

Technical Specifications

- Body material: forged brass nickel plated
- Ball material: brass nickel/chrome plated
- Body seal: Teflon PTFE
- Shaft seal: nitrile 2 x NBR (max. temp + 90°C)
- Handle: nylon 6:6 - glass fibre reinforced (max. temp+ 210°C)
- Max. operating pressure: 20 bar
- Anti-blow out stem
- Full bore operation - minimum pressure drop
- 1/4 turn positive shut-off
- 100% factory tested
- Conforms to European Standard for Gas Valves - EN 331:1995
- Also suitable for diesel

A range of mini gas ball valves with integral foot mount

COMPRESSION x COMPRESSION OR 8MM NOZZLE

These valves are designed for pipe to pipe applications or hose to copper pipe with an integral foot mount for a secure hold without additional pipe supports. All come complete with nuts and brass olives.

Compression	x Compression	Part No.	x Hose ID	Part No.
1/4"	1/4"	1-59100	8mm	1-59120
5/16"	5/16"	1-59101	8mm	1-59121
3/8"	3/8"	1-59102	8mm	1-59122

BSP FEMALE x FEMALE WALL MOUNTED VALVES

These valves are designed for wall or panel mounting and are fitted with adjustable steel wall brackets.

Part No.	Description
1-59115	1/4" BSP Female / Female and wall bracket
1-59117	1/2" BSP Female / Female and wall bracket

15mm x15mm VALVE WITH COMPRESSION FITTINGS

This valve is designed for wall or panel mounting & is complete with steel wall bracket. It has a 13mm ball aperture for minimum pressure drop. Comes complete with nuts & brass olives. **Part No. 1-59109**

Note: if installing in a gas system using copper pipe the brass olives must be exchanged for copper olives to comply with EN ISO 10239:2000 (6.2.4)

- 1-19024** 1/4" pack of 10 Copper compression olives
- 1-19025** 5/16" pack of 10 Copper compression olives
- 1-19026** 3/8" pack of 10 Copper compression olives

TRADITIONAL GAS FLOOR MOUNT TAP

- Compression x LP 8mm Nozzle
- Chrome Plated
- Locked Closed Position

1/4" **Part No. 1-59030**

5/16" **Part No. 1-59032**

TRADITIONAL GAS FLOOR MOUNT TAP

- Compression x Compression
- Chrome Plated
- Locked Closed Position

1/4" x 1/4" **Part No. 1-59031**

5/16" x 5/16" **Part No. 1-59033**

3/8" x 3/8" **Part No. 1-59035**

Kit contains:

- 2 x 30" W20 Pigtails
- 2 x W20 T Pieces

4 CYLINDER UPGRADE KIT

- For use with manual, automatic & high pressure changeovers
- Propane only
- Enable upgrade from 2 to 4 cylinders

Part No. 1-59022

BUBBLE GAS LEAK DETECTOR

This leak detector is designed to be connected close to the outlet side of the gas regulator. It then provides an instant visible check for leaks. Bubbles in the sightings chamber indicate a leak downstream of the bubble tester.

Supplied complete with fluid. It may be used in boats, caravans and other applications.

The Boat Safety Scheme states that "an approved bubble tester is highly recommended". The bubble tester is approved under the BSS.

Part No. N-29001 8mm
Part No. N-29002 10mm

Technical Specification:	
Dimensions (HxWxD):	90 x 60 x 30mm
Max. working pressure:	2 bar (29.4psi)
Capacity:	12kW
Pipe connections:	8mm/10mm compression inlet & outlet

Spare Fluid: **N-29003** (Fluid)

CAMPING GAZ ADAPTER

- Butane Regulator Adaptor
- Fits Camping Gaz 901, 904, 907 cylinders

Part No. 1-59095

GAS LEAK DETECTOR FLUID SPRAY

Solution comes in a durable plastic spray 500ml bottle.

Part No. 1-59073

Aquafax undertakes to supply gas appliances or fittings on the assumption that the installer is qualified and competent.

GAS HOSES TO BS 3212 (TYPE 2) RCD APPROVED



GAS HOSE ASSEMBLIES

- Made in high pressure orange hose (not to exceed 17.5 Bar) and fitted with copper extension spigots held by swaged S/S ferrules. RCD and BSS approved up to 1m.
- S/S metal braided outer for use in installations where hose is subject to movement abrasion.
- Longer sizes available to order (may be subject to minimum order quantity).

Length	SPIGOT SIZE							
	1/4"		5/16"		3/8"		1/2"	
	Orange	Braided	Orange	Braided	Orange	Braided	Orange	Braided
18"	1-58418	1-58418B	1-58518	1-58518B	1-58618	1-58618B	-	-
24"	1-58424	1-58424B	1-58524	1-58524B	1-58624	1-58624B	1-58724	-
30"	1-58430	1-58430B	1-58530	1-58530B	1-58630	1-58630B	1-58730	1-58730B
36"	1-58436	1-58436B	1-58536	1-58536B	1-58636	1-58636B	1-58736	1-58736B
42"	-	1-58442B	-	1-58542B	1-58642	1-58642B	-	-

ORANGE GAS HOSE IN COILS BS3212 (TYPE 2)



Bore	10m Coil	50m Coil
6.3mm 1/4"	1-59056	1-59051
8mm 5/16"	1-59057	1-59052
9.5mm 3/8"	1-59058	1-59053



ROCOL GASSEAL NON-SETTING SEALANT

- Non-toxic, non hardening gas joint sealer
- Available in 100 gram tubes
- Independently tested by BSI to BS EN 751-2:1997 Part 2 Class B
- Suitable for threads or flanges
- Joints can be assembled & pressure tested immediately

Part No. 1-59070



PLASTICOLL X10 GAS JOINTING PASTE

Meets the BS requirements of BS 6956 part 6, which specifically cover LPG. BS EN 751-2:1997

600g – Part No. 1-59075

HEAVY WEIGHT SPANNER

- For Butane and Propane Nuts
- Length: 205mm

Part No. 1-59041



LIGHT WEIGHT SPANNER

- For Butane and Propane Nuts
- Length: 160mm

Part No. 1-59040



PTFE GAS THREAD SEALING TAPE

- A premier grade pure PTFE tape for thread sealing particularly recommended for natural gas and LPG
- Resistant to most chemicals, acids, alkalis etc.
- Temperature range -240°C to +260°C
- Complies with BS 6974 and BS EN 751-3 1997



Width	Length	Thickness	Part No.
12mm	5m	.20mm	1-79001

COMMERCIAL GRADE PTFE TAPE

Sold per 10

- Suitable for metal, and plastic thread sealing
- Resistant to water, air, steam and most chemicals
- Complies with BS 7786 and BS 4375 requirements
- Temp Range: -240°C to +260°C

Width	Length	Thickness	Part No.
12mm	12m	.075mm	1-79000





COPPER WASHERS

Sold per 10
• For BSP Male Thread

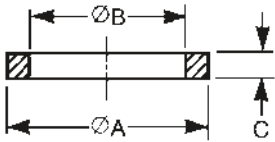

Part No.	Size (Approx.)			
	BSP	A	B	C
1-19599		11	6.7	1.5
1-19600	1/8"	15	10	1.5
1-19601	1/4"	18	13	1.5
1-19602	3/8"	24	17	1.5
1-19603	1/2"	28	21	1.5
1-19604	5/8"	30	24	2.0
1-19605	3/4"	34	27	2.0
1-19606	1"	38	33	2.5



SADDLE CLAMPS

Sold per 10
• Copper pressings

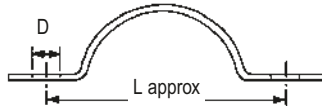

Part No.	Tube OD	L mm	D mm
1-50201	3/16"	16	2
1-50202	1/4"	16	3
1-50203	5/16"	18	3
1-50204	3/8"	22	3
1-50206	1/2"	27	4.5
1-50208	3/4"	35	6
1-50210	1"	45	6



'O' CLIPS

Sold per 10

Tube OD	Part No.
3/16"	1-19830
1/4"	1-19831
5/16"	1-19832
3/8"	1-19833
1/2"	1-19834
9/16"	1-19835
5/8"	1-19836
7/16"	1-19837
3/4"	1-19838



NYLORACK TUBE CLIPS

Sold per 10

Tube OD	Way	Part No.
3/16"	1	1-19800
1/4"	1	1-19801
5/16"	1	1-19802
3/8"	1	1-19803
1/2"	1	1-19804
3/16"	2	1-19805
1/4"	2	1-19806
5/16"	2	1-19807
3/8"	2	1-19808
1/2"	2	1-19809
3/16"	3	1-19810
1/4"	3	1-19811
5/16"	3	1-19812
3/8"	3	1-19813



WASHERS (FIBRE)

Sold per 10
• Inca fibre washers are a durable jointing for general purpose, medium performance duties
• Suitable for steam, condensate, water, air, oils, solvents
• 1.5mm thick
• Meets all requirements of BS7531 Grade Y
• WRAS approved for use with hot and cold potable water up to 85°C

BSP	OD mm	ID mm	Part No.
1/8"	14	10	1-79100
1/4"	19	13	1-79101
3/8"	24	18	1-79102
1/2"	29	21	1-79103
5/8"	30	23	1-79104
3/4"	34	26	1-79105
7/8"	42	33	1-79106
1"	44	35	1-79107

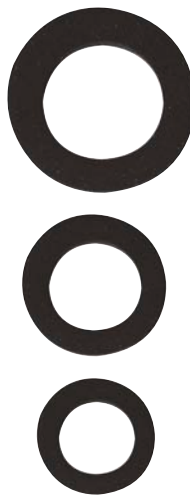

NITRILE WASHERS

Each
• For BSP(F) joints as inside female threaded hose connectors
• Thickness approx. 3mm
• Suitable for water or oil

BSP	OD mm	ID mm	Part No.
1/2"	21	14	1-72231
3/4"	24	17	1-72232
1"	34	22	1-72233
1 1/4"	41	20	1-72234
1 1/2"	49	34	1-72235
2"	61	45	1-72236
2 1/2"	76	57	1-72237
3"	88	69	1-72238

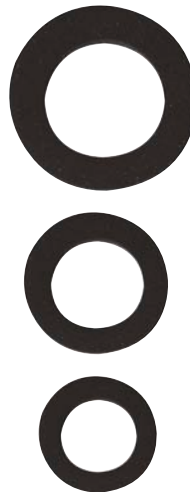

NITRILE WASHERS

Each
• For fitting over male BSP threads as on tank fittings, male threaded hose connections etc.
• Thickness approx. 3mm
• Suitable for water or oil

BSP	OD mm	ID mm	Part No.
3/8"	27	17	1-72220
1/2"	38	21	1-72221
3/4"	45	27	1-72223
1"	50	34	1-72224
1 1/4"	68	43	1-72225
1 1/2"	76	49	1-72226
2"	88	61	1-72227
2 1/2"	112	71	1-72228
3"	125	88	1-72229

NITRILE 'O' RINGS

Sold per 10

• A basic range to fit either BSP(M) or BSP(F) threaded joints suitable for water, oil, petrol, etc.
• To BS 1806 standard.
• Sizes are approx.
• Temp. range approx: -30 to +120°C



Dia. ID	ID	OD	BSP(M)	BSP(F)	Part No.
1.78	5	8.5	-	1/8"	1-79208
1.78	7.5	11	-	1/4"	1-79211
1.78	9.5	12.5	1/8"	-	1-79212
1.78	11.5	14.5	-	3/8"	1-79213
1.78	12.5	16	1/4"	-	1-79214
1.78	15.5	19	3/8"	1/2"	1-79216
1.78	19	22.5	1/2"	-	1-79218
2.62	6	11	-	1/4"	1-79308
2.62	7.5	12.5	-	-	1-79309
2.62	9.5	14	1/8"	3/8"	1-79310
2.62	11	16	-	-	1-79311
2.62	14	19	-	1/2"	1-79313
2.62	17	22	-	-	1-79315
2.62	19	24	1/2"	3/4"	1-79316
2.62	23	28.5	-	-	1-79319
2.62	25	30	3/4"	1	1-79320
2.62	32	38	1	-	1-79325
2.62	40	47	1 1/4"	1 1/2"	1-79330
2.62	45	51	1 1/2"	-	1-79333
3.53	32	40	-	1 1/4"	1-79419
3.53	38	45	1 1/4"	1 1/2"	1-79422
3.53	46	54	1 1/2"	-	1-79425
3.53	59	66	2"	-	1-79429
3.53	74	82	2 1/2"	-	1-79434

CARDED LINES



Card style 330mm high x 240mm wide*

1 METRE ORANGE GAS HOSE TO BS3212 (TYPE 2)

Part No.	Description
1-59051/KU	1M Orange Gas Hose 6.3mm ID + 2x S/S Hose Clips (1-87112)
1-59052/KU	1M Orange Gas Hose 8.0mm ID + 2x S/S Hose Clips (1-87116)
1-59053/KU	1M Orange Gas Hose 9.5mm ID + 2x S/S Hose Clips (1-87120)

ISO 7840 A1 FUEL HOSE WITH S/S HOSE CLIPS

1M Part No.	Description
1-57820/KU	Fuel Hose 6mm ID + 2x S/S Hose Clips (1-87116)
1-57821/KU	Fuel Hose 8mm ID + 2x S/S Hose Clips (1-87120)
1-57822/KU	Fuel Hose 10mm ID + 2x S/S Hose Clips (1-87120)
1-57823/KU	Fuel Hose 13mm ID + 2x S/S Hose Clips (1-87125)

*Other card sizes may be available to order up to 480mm high x 330mm wide

10 ASSORTED COPPER WASHERS

Part No. 1-19610Z

Contains: 1 x 1/8" BSM (1-19600)
 4 x 1/4" BSM (1-19601)
 3 x 3/8" BSM (1-19602)
 2 x 1/2" BSM (1-19603)



10 ASSORTED BRASS COMPRESSION RINGS

Part No. 1-19010Z

Contains: 2 x 1/4" (1-19014)
 3 x 5/16" (1-19015)
 3 x 3/8" (1-19016)
 2 x 1/2" (1-19012)



10 ASSORTED COPPER COMPRESSION RINGS

Part No. 1-19030Z

Contains: 2 x 1/4" (1-19024)
 3 x 5/16" (1-19025)
 3 x 3/8" (1-19026)
 2 x 1/2" (1-19027)



Examples of carded products

We can, providing items are not too heavy or bulky, put most products from all sections on to display cards. Please see overleaf.



DISPLAY PACKING AND BAR CODING



Aquafax now offers certain products skin packed onto a display card and bar coded. A price list of those products is currently available. We will also consider any products you think suitable for skin packing. Please state on your order form if you want an item carded as it will cost slightly more. We will arrange a suitable card size for the product.

HOW IT WORKS

The new part number will be the existing part number plus a letter on the end which denotes the card size. i.e. **2-60101** when carded is **2-60101Y**

At present we are using seven different card sizes with a euro slot for hanging. The card is purple in colour and has the Aquafax logo printed on it faintly.

DISPLAY STANDS

We have white, revolving display stands available. These are issued free on loan with a £500 stocking order. Blank cards stating the part for re-ordering are available on request.

BAR CODING

All products are bar-coded with a unique number.

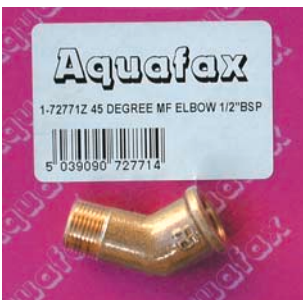

CARD SIZES AND ORDERING

Please allow an extra 24 hours for carding. To minimise wastage of card and to keep costs down please try to order in multiples as shown below when re-ordering.

Product Code Suffix	Approximate Width	Card Sizes Height	Order in Multiples of
T	330mm	480mm	1
U	240mm	330mm	2
V	160mm	330mm	3
W	165mm	240mm	4
X	110mm	240mm	6
Y	110mm	160mm	9
Z	110mm	120mm	12

Discounts and carriage terms remain the same.

